

Insert

Instructions for Use



for concealed pipe interrupter

Model
6161.82

Year built:
from 01/1991

en_INT

viega

Table of contents

1	About these instructions for use	4
1.1	Target groups	4
1.2	Labelling of notes	4
1.3	About this translated version	5
2	Product information	6
2.1	Area of application	6
2.2	Product description	6
3	Handling	7
3.1	Assembly	7
3.1.1	Replacing the insert	7
3.2	Disposal	8

1 About these instructions for use

1.1 Target groups

The information in this instruction manual is directed at the following groups of people:

- Heating and sanitary professionals and trained personnel

It is not permitted for individuals without the abovementioned training or qualification to mount, install and, if required, service this product. This restriction does not extend to possible operating instructions.

The installation of Viega products must take place in accordance with the general rules of engineering and the Viega instructions for use.

1.2 Labelling of notes

Warning and advisory texts are set aside from the remainder of the text and are labelled with the relevant pictographs.



DANGER!

This symbol warns against possible life-threatening injury.



WARNING!

This symbol warns against possible serious injury.



CAUTION!

This symbol warns against possible injury.



NOTICE!

This symbol warns against possible damage to property.



Notes give you additional helpful tips.

1.3 About this translated version

This instruction for use contains important information about the choice of product or system, assembly and commissioning as well as intended use and, if required, maintenance measures. The information about the products, their properties and application technology are based on the current standards in Europe (e. g. EN) and/or in Germany (e. g. DIN/DVGW).

Some passages in the text may refer to technical codes in Europe/Germany. These should serve as recommendations in the absence of corresponding national regulations. The pertinent national laws, standards, regulations and guidelines, as well as other technical guidelines, have priority over German/European guidelines in this manual: The information is not binding for other countries and territories and should, as mentioned, be considered as support.

2 Product information

2.1 Area of application

The insert is suitable as a spare part for the concealed pipe interrupter, model 6161.81.

The insert must be replaced in the case of extreme contamination or limescale. Depending on the local water quality, a maintenance interval should be set out for the replacement of each pipe interrupter.

2.2 Product description

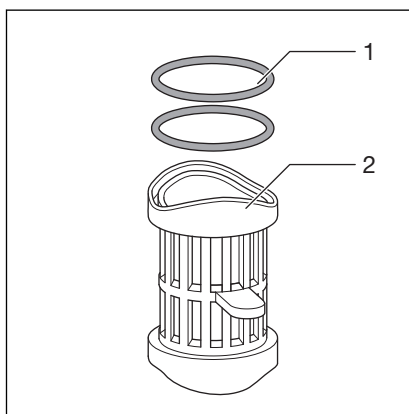

Fig. 1: Pipe interrupter insert

- 1 - O-rings
- 2 - Pipe interrupter insert

The insert is delivered with two O-rings as seals, which are already fitted when delivered. The seal rings are inserted (one on top, one below) in a recess in the rim of the insert. If a seal falls out, it can be re-inserted.

3 Handling

3.1 Assembly

3.1.1 Replacing the insert

The pipe interrupter must be cleaned regularly as limescale on the membrane can be detrimental to its functionality. The cleaning interval depends from the local water and should be decided during mounting.

Proceed as follows to replace the insert with the membrane:

➤ Remove rosette.

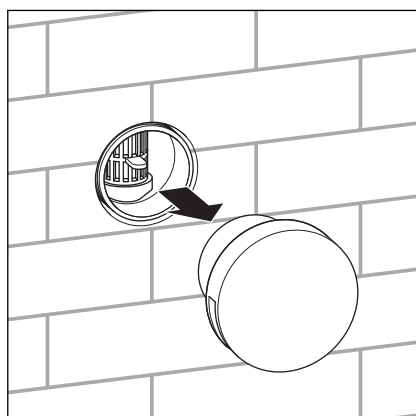

➤ Pull the insert out of the casing using multigrip pliers.

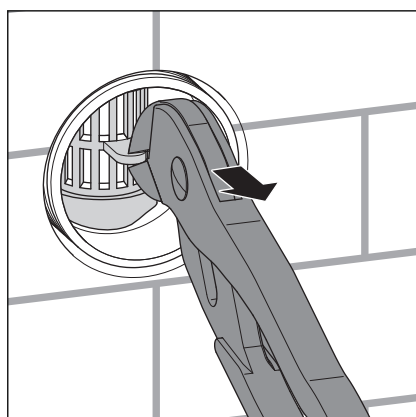

➤ If one of the O-rings has fallen out, insert O-ring in the recess on the upper and lower edge of the insert.

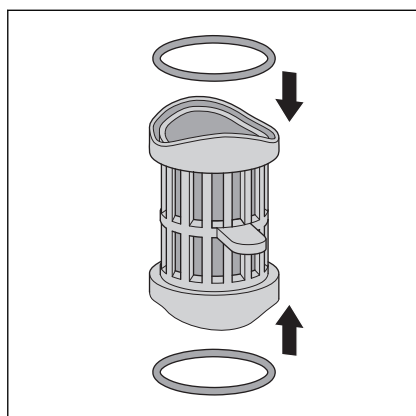

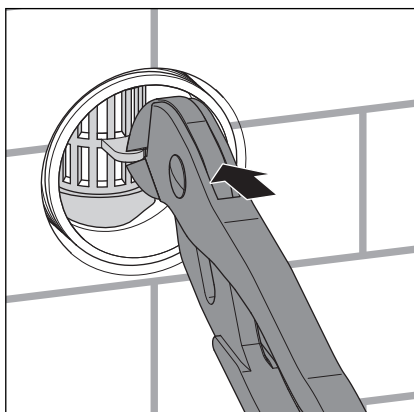

- Using multigrip pliers, insert the insert into the casing of the pipe interrupter vertically from the front.

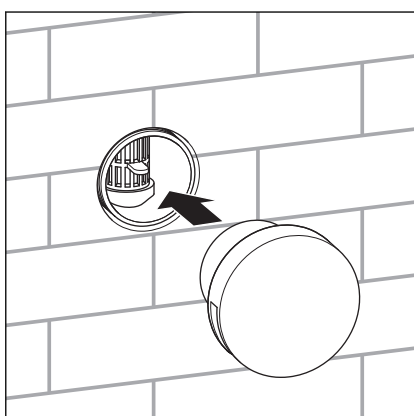

- Insert the rosette into the shaft top.

3.2 Disposal

Separate the product and packaging materials (e. g. paper, metal, plastic or non-ferrous metals) and dispose of in accordance with valid national legal requirements.