

Prevista Dry support bracket

Instructions for Use

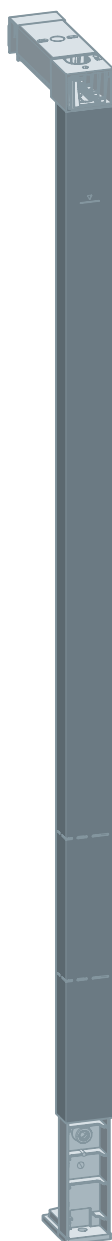

for interval > 500 mm, fixing to wall

Model
8570.48

en_INT

viega

Table of contents

1	About these instructions for use	4
1.1	Target groups	4
1.2	Labelling of notes	4
1.3	About this translated version	5
2	Product information	6
2.1	Intended use	6
2.1.1	Areas of use	6
2.2	Product description	6
2.2.1	Overview	6
3	Handling	7
3.1	Assembly information	7
3.1.1	Installation dimensions	7
3.2	Assembly	8
3.2.1	Mounting support bracket	8
3.3	Disposal	15

1 About these instructions for use

Trade mark rights exist for this document; for further information, go to viega.com/legal.

1.1 Target groups

The information in this instruction manual is directed at the following groups of people:

- Heating and sanitary professionals and trained personnel

Individuals without the abovementioned training or qualification are not permitted to mount, install and, if required, maintain this product. This restriction does not extend to possible operating instructions.

The installation of Viega products must take place in accordance with the general rules of engineering and the Viega instructions for use.

1.2 Labelling of notes

Warning and advisory texts are set aside from the remainder of the text and are labelled with the relevant pictographs.



DANGER!

This symbol warns of possible life-threatening injury.



WARNING!

This symbol warns of possible serious injury.



CAUTION!

This symbol warns of possible injury.



NOTICE!

This symbol warns of possible damage to property.



This symbol gives additional information and hints.

1.3 About this translated version

This instruction for use contains important information about the choice of product or system, assembly and commissioning as well as intended use and, if required, maintenance measures. The information about the products, their properties and application technology are based on the current standards in Europe (e.g. EN) and/or in Germany (e.g. DIN/DVGW).

Some passages in the text may refer to technical codes in Europe/Germany. These should serve as recommendations in the absence of corresponding national regulations. The relevant national laws, standards, regulations, directives and other technical provisions take priority over the German/European directives specified in this manual: The information herein is not binding for other countries and regions; as said above, they should be understood as a recommendation.

2 Product information

2.1 Intended use

2.1.1 Areas of use

The Prevista Dry support bracket is used for the connection of multiple Prevista Dry elements at an interval of more than 500 mm to enable a stable cladding.

2.2 Product description

2.2.1 Overview

The support bracket can be attached directly to wall and floor or onto mounting rails.

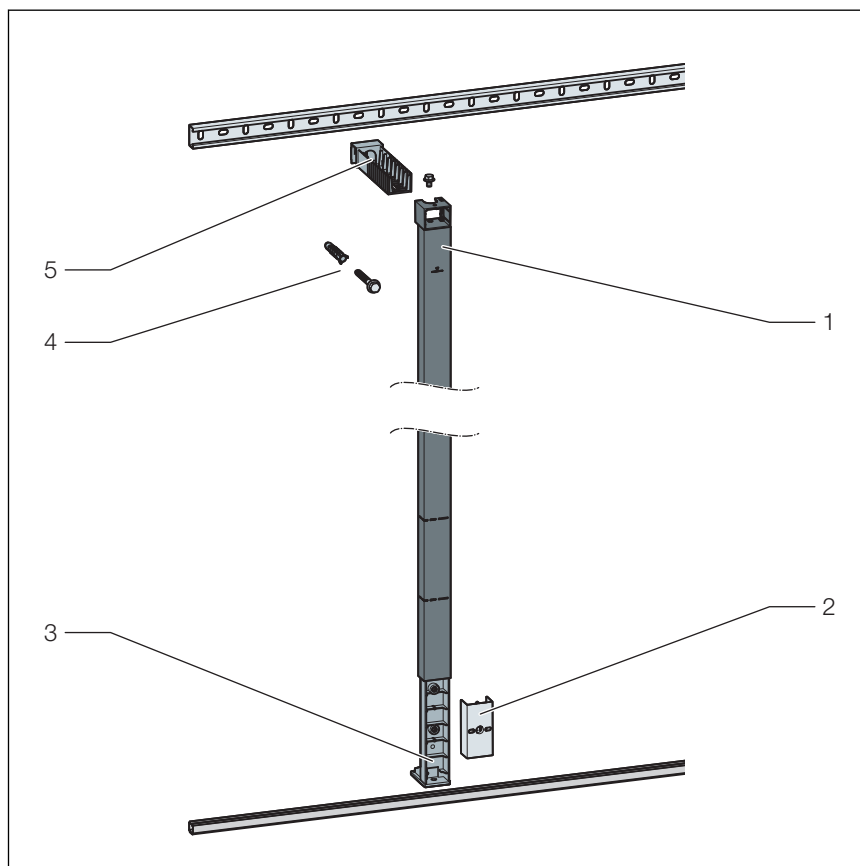

Fig. 1: Components

- 1 support bracket
- 2 cover cap
- 3 floor support
- 4 fixing material
- 5 wall bracket

3 Handling

3.1 Assembly information

3.1.1 Installation dimensions

Dimensions

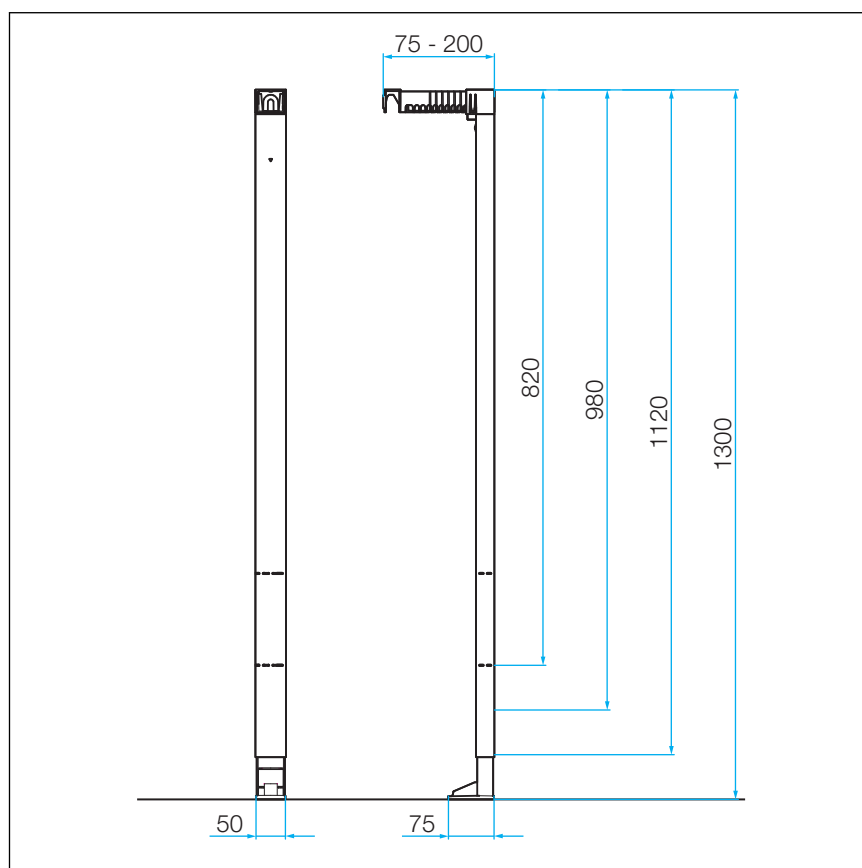

Fig. 2: Dimensions

Maximum intervals

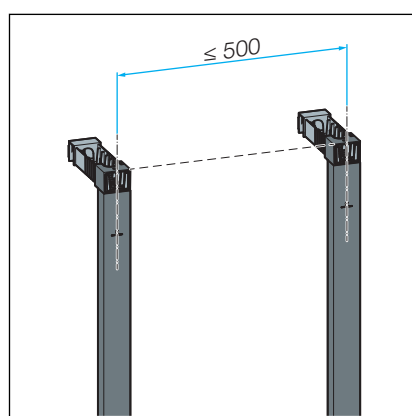

Fig. 3: Maximum interval between Prevista Dry support brackets

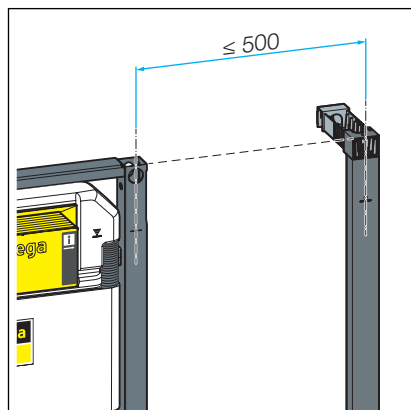
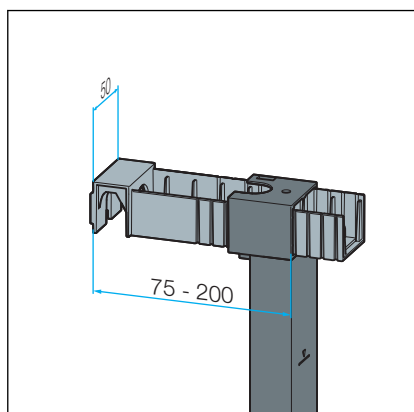
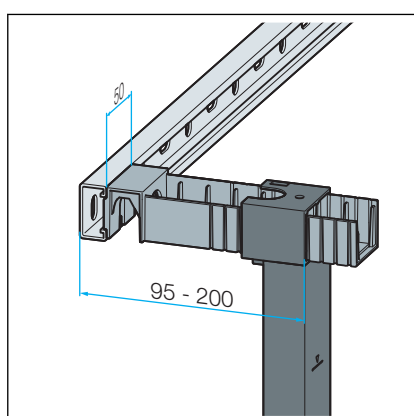

Fig. 4: Maximum interval between Prevista Dry support bracket and Prevista Dry element

Possible interval when fixing to wall without mounting rail



Possible interval when fixing to wall on mounting rail



3.2 Assembly

3.2.1 Mounting support bracket

The support bracket can be attached directly to the wall or onto a fixing rail (model 8001).

Mounting preparation

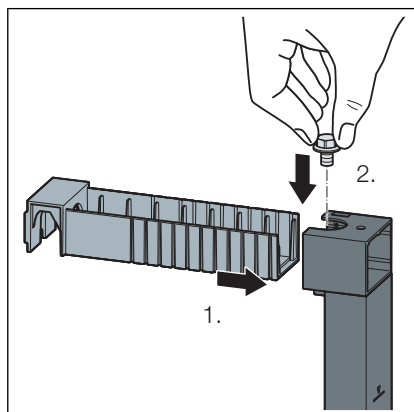

- Push in the wall bracket.
- Screw in the wall bracket fixing screw hand-tight.

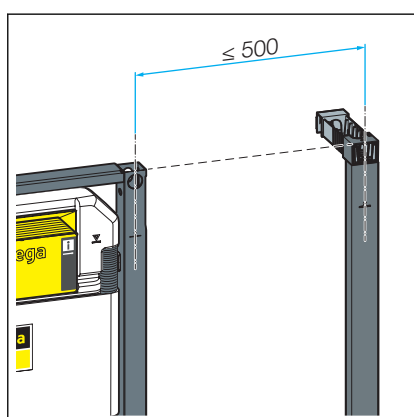

- Determine and mark the fixing point on the wall (in relation to the neighbouring element).

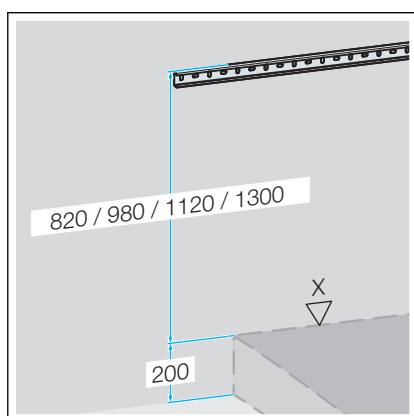

- If necessary, secure the mounting rail at a height in relation to the neighbouring element. Whilst doing so, observe on-site marking of the upper edge of the finished floor.

INFO! The construction height must be determined and adhered to exactly.

There are only limited possibilities available to remedy errors made during this assembly step, ↗ Chapter 3.1.1 „Installation dimensions“ on page 7.

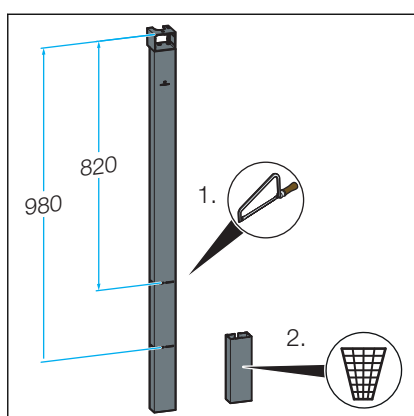

- Cut the support bracket to the determined / required length.
- Dispose of the sawn-off piece.

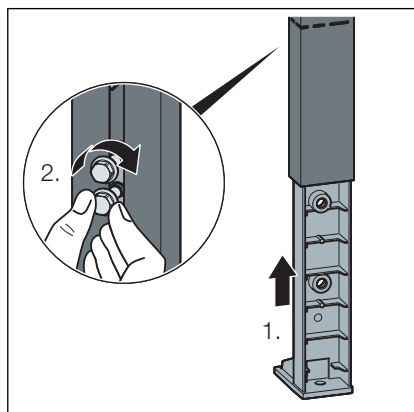

- Push the floor support into the support bracket.
- Tighten the floor support fixing screws hand-tight.

Fixing on a masonry wall

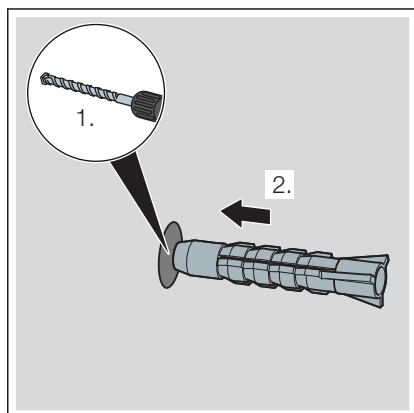

- Drill the holes (10 mm).
- Insert the dowel.

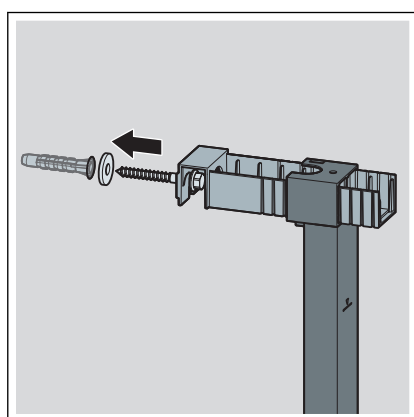

- Screw the fixing screw into the dowel through wall bracket.
- Tighten the fixing screw.

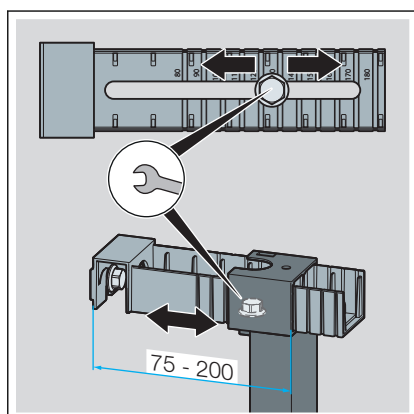

- Determine the interval to wall in relation to the neighbouring element.
- Loosen the wall bracket fixing screw.
- Push the support bracket to the determined interval to wall.
- Tighten the wall bracket fixing screw hand-tight.

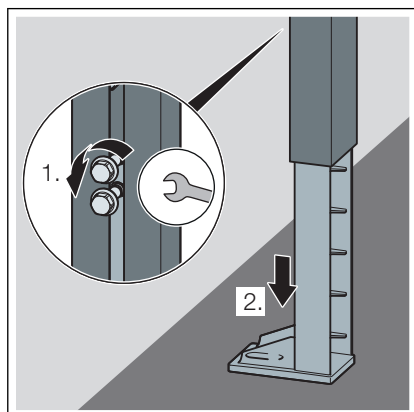

- Loosen the floor support fixing screws and lower the floor support onto the floor.

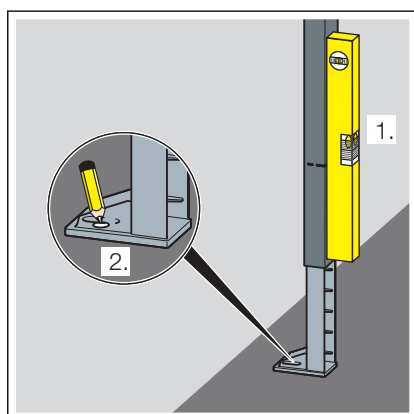

- Align the support bracket vertically with a spirit level.
- Mark the fixing point on the floor.

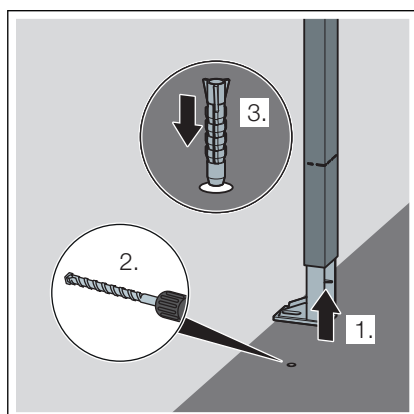

- Drill the hole (10 mm) and insert the dowel.

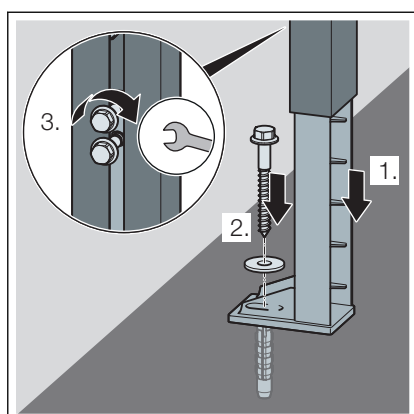

- Attach the floor support to the floor.
- Tighten the floor support fixing screws.

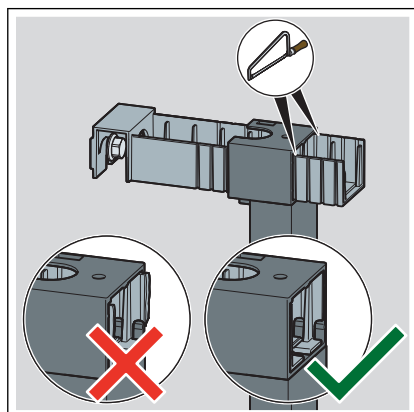

- Tighten the wall bracket fixing screw.
- Cut the surplus part of the wall bracket flush.

INFO! Cut flush carefully, otherwise proper cladding is not possible.

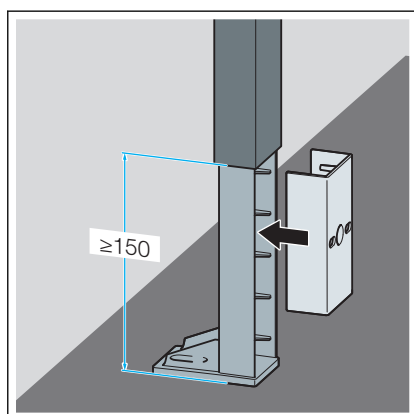

- If necessary, align the cover cap with the fixing drill hole in the floor support and push until it clicks into place (≥ 150 mm floor interval).

Fixing on mounting rails

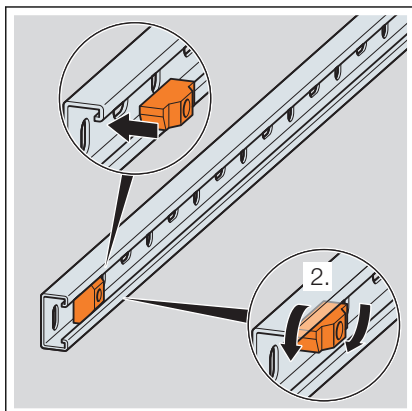

- Insert the slot nut and turn vertically.

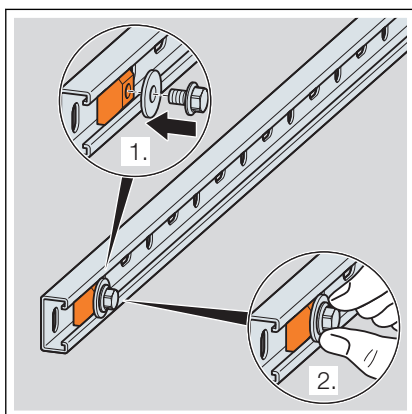

- Insert the fixing screw.
- Tighten the fixing screw hand tight.

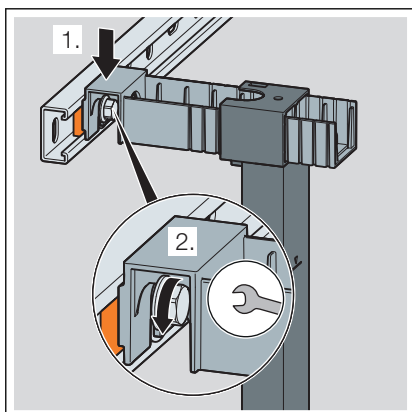

- Hang the wall bracket with the support bracket between the mounting rail and the washer.
- Tighten the fixing screw.

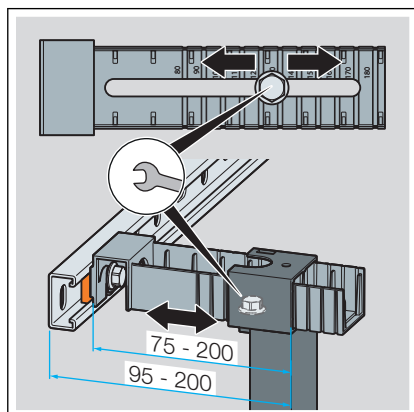

- Determine the interval to wall in relation to the neighbouring element.
- Loosen the wall bracket fixing screw.
- Push the support bracket to the determined interval to wall.
- Tighten the wall bracket fixing screw hand-tight.

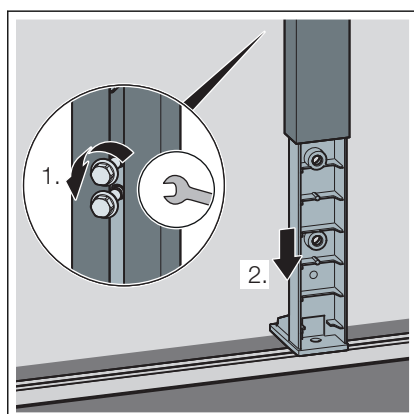

- Loosen the floor support fixing screws and lower the floor support onto the floor rail.

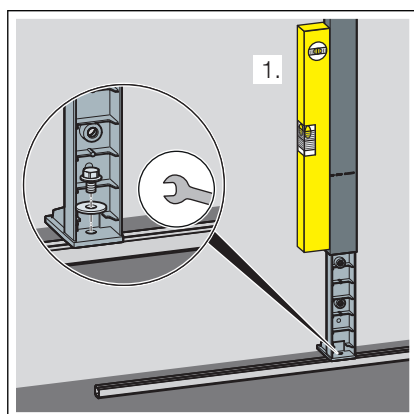

- Align the support bracket vertically with a spirit level.
- Secure the floor support on the floor rail.
- Tighten the floor support fixing screws.

3.3 Disposal

Separate the product and packaging materials (e. g. paper, metal, plastic or non-ferrous metals) and dispose of in accordance with valid national legal requirements.