

Urinal module

Instructions for Use

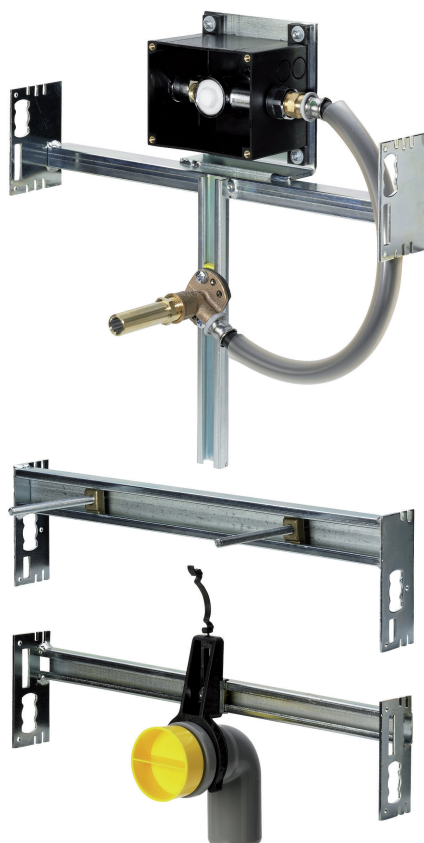

for urinal with concealed flushing system, for connection of the
Visign equipment set (manual and touchless flush actuation)

Model
8128.33

Year built:
from 03/2009

en_INT

viega

Table of contents

1	About these instructions for use	4
1.1	Target groups	4
1.2	Labelling of notes	4
1.3	About this translated version	5
2	Product information	6
2.1	Standards and regulations	6
2.2	Intended use	6
2.2.1	Areas of use	6
2.3	Product description	7
2.3.1	Overview	7
2.3.2	Compatible components	7
2.3.3	Sound protection	7
2.3.4	Technical data	8
3	Handling	9
3.1	Assembly	9
3.1.1	Mounting the urinal module	9
3.2	Disposal	11

1 About these instructions for use

Trade mark rights exist for this document, further information can be found at viega.com/legal.

1.1 Target groups

The information in this instruction manual is directed at the following groups of people:

- Heating and sanitary professionals and trained personnel
- Drywall builder

It is not permitted for individuals without the abovementioned training or qualification to mount, install and, if required, maintain this product. This restriction does not extend to possible operating instructions.

The installation of Viega products must take place in accordance with the general rules of engineering and the Viega instructions for use.

1.2 Labelling of notes

Warning and advisory texts are set aside from the remainder of the text and are labelled with the relevant pictographs.



DANGER!

This symbol warns against possible life-threatening injury.



WARNING!

This symbol warns against possible serious injury.



CAUTION!

This symbol warns against possible injury.



NOTICE!

This symbol warns against possible damage to property.



Notes give you additional helpful tips.

1.3 About this translated version

This instruction for use contains important information about the choice of product or system, assembly and commissioning as well as intended use and, if required, maintenance measures. The information about the products, their properties and application technology are based on the current standards in Europe (e. g. EN) and/or in Germany (e. g. DIN/DVGW).

Some passages in the text may refer to technical codes in Europe/Germany. These should serve as recommendations in the absence of corresponding national regulations. The relevant national laws, standards, regulations, directives and other technical provisions take priority over the German/European directives specified in this manual: The information herein is not binding for other countries and regions; as said above, they should be understood as a recommendation.

2 Product information

2.1 Standards and regulations

The following standards and regulations apply to Germany / Europe. National regulations can be found on the relevant web site of your country at viega.com/standards.

Regulations from section: Sound protection

Scope / Notice	Regulations applicable in Germany
Fulfilled noise protection requirements	DIN 4109
Fulfilled noise protection requirements	DIN 4109 (additional sheet 2)
Fulfilled noise protection requirements	VDI 4100 SSt I-SSt II

2.2 Intended use

2.2.1 Areas of use

The urinal module is designed for mounting in a concealed flushing system.

2.3 Product description

2.3.1 Overview

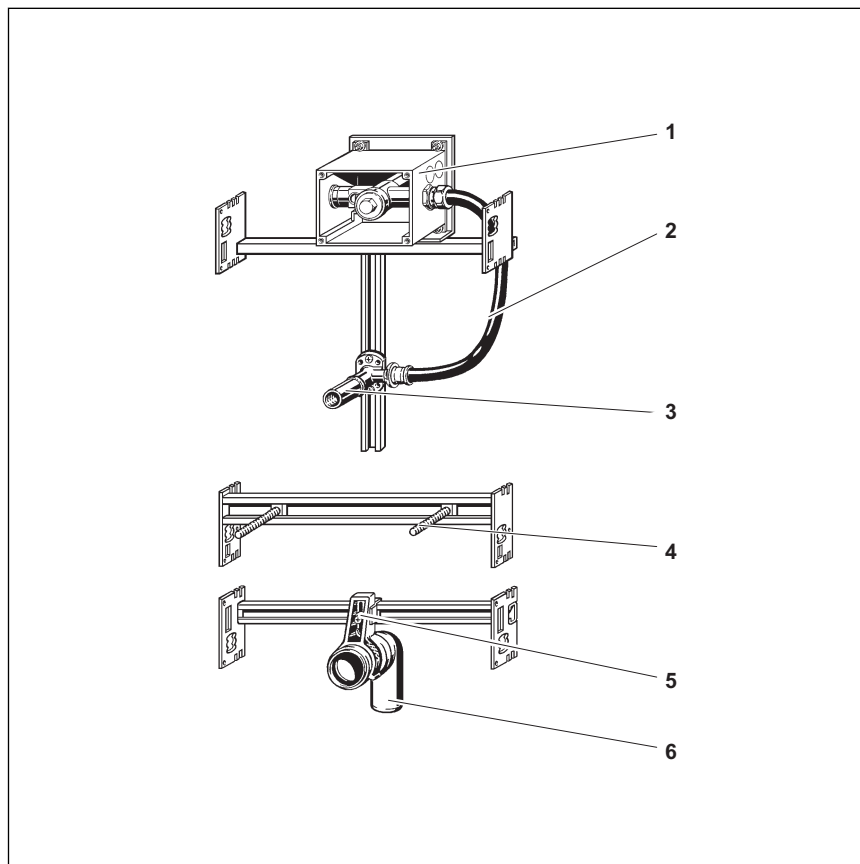

Fig. 1: Components

- 1 - installation set
- 2 - water inlet
- 3 - supply fitting
- 4 - threaded bolts for fixing sanitary objects
- 5 - mounting bracket for drain elbow
- 6 - drain elbow

2.3.2 Compatible components

The urinal module is compatible with the Visign equipment sets for manual and touchless flush actuation.

An overview of the connectable urinal ceramics can be found in the catalogue.

2.3.3 Sound protection

The urinal module complies with the noise insulation requirements specified in section  „Regulations from section: Sound protection“ on page 6.

2.3.4 Technical data

The product has the following technical data:

drain elbow	DN 50
Fitting connection	Rp ½
Maximum height of urinal inlet from upper edge of the finished floor	<ul style="list-style-type: none"> ■ with basic element construction height 1130 = 880 mm ■ with basic element construction height 1370 = 1120 mm

3 Handling

3.1 Assembly

3.1.1 Mounting the urinal module

Securing crossbeam modules

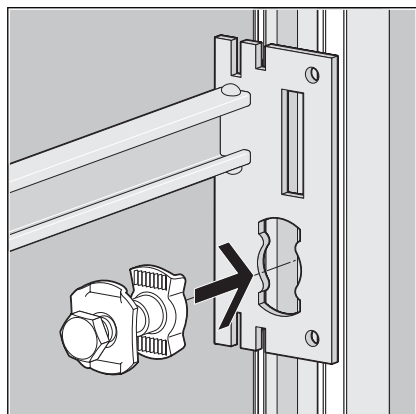

- Secure the module onto the open side of the Steptec rail with the slot nuts supplied.

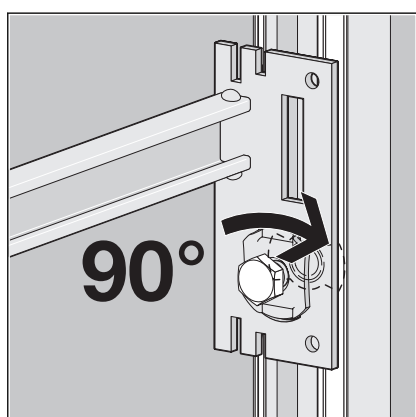

- Press the slot nut in gently and secure in the open rail side with a 90° turn.

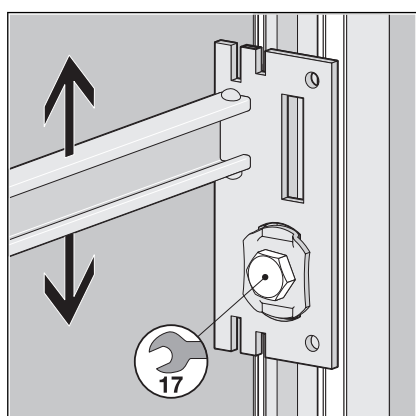

- Tighten slot nut with a fork spanner (SW 17).

Mounting the module in Viega Steptec

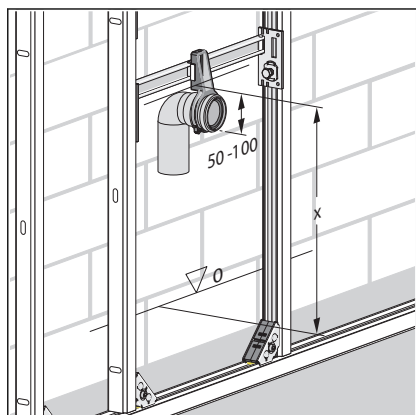

- Mount drain elbow in mounting bracket.
- Secure with a bracket.
- Set height of the drain elbow (50 mm).

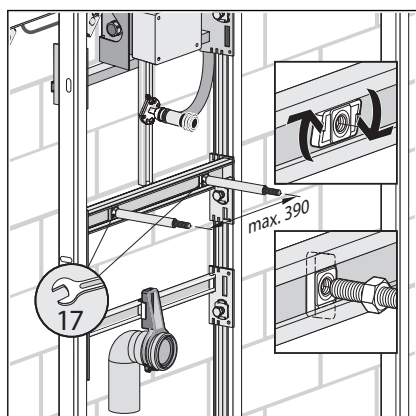

- Mount threaded bolts.

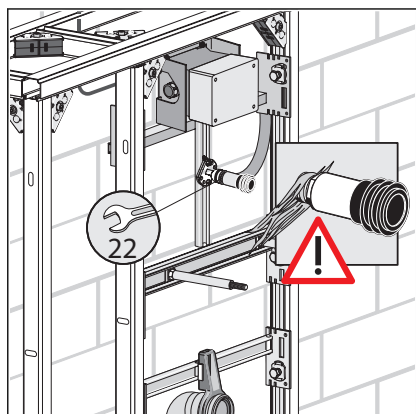

- Seal supply fitting.
- Screw supply fitting into the wall plate.

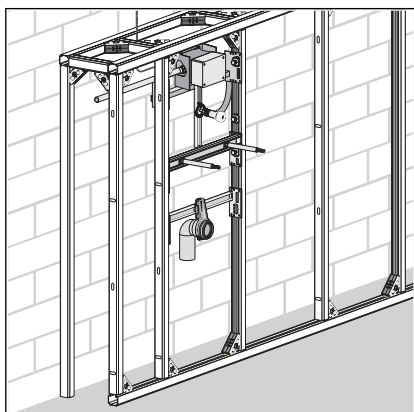

- Connect water line.

DANGER! Risk of electric shock

- Work on the electrics may only be carried out by trained electricians.
- Always de-energise the connection line before work is commenced.

- Lay the electrical cable in the installation set.

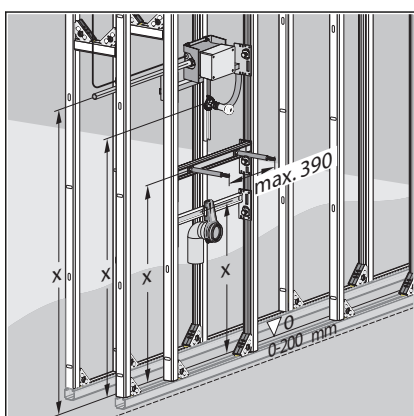

- If necessary, align the height of the urinal element.

INFO! Observe the ceramic manufacturer's information when aligning the connections.

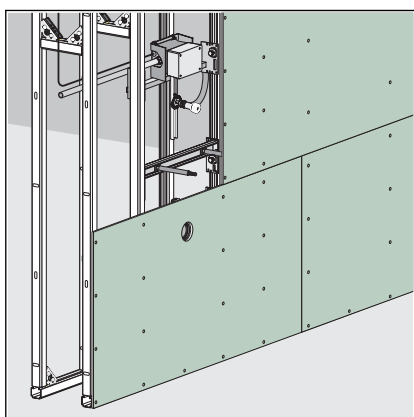

- Clad urinal element (1 x 12.5 mm).

3.2 Disposal

Separate the product and packaging materials (e. g. paper, metal, plastic or non-ferrous metals) and dispose of in accordance with valid national legal requirements.