

Instructions for Use

WC flush plate for Prevista tile-level

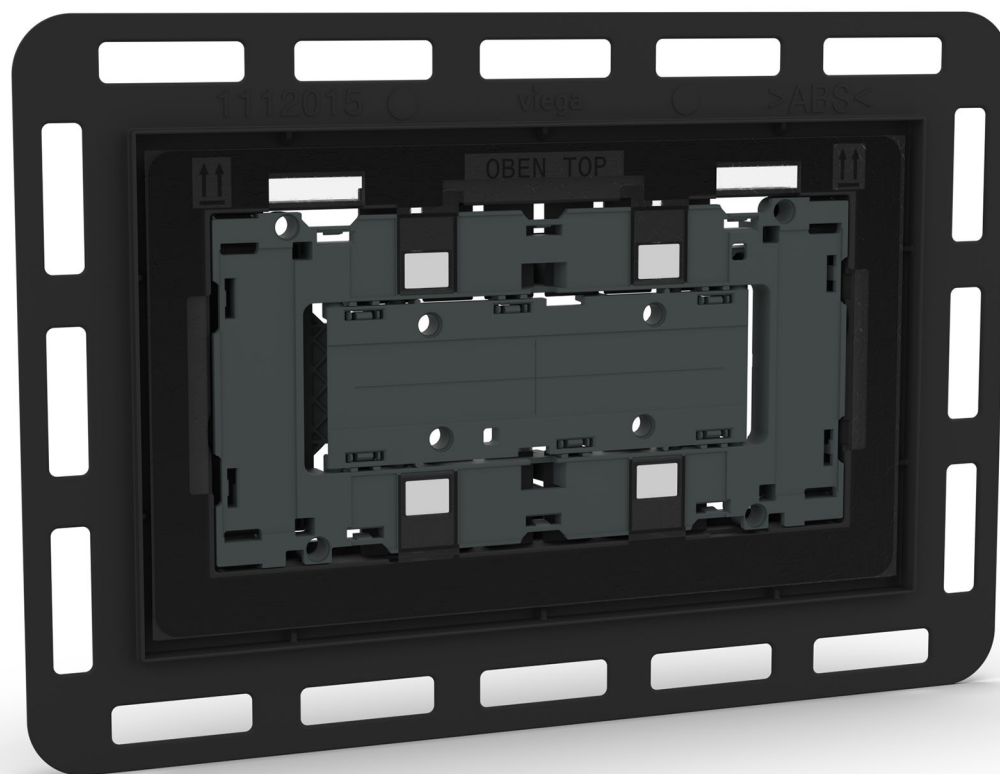

for all Prevista concealed cisterns, wet and dry construction,
covering with on-site wall tiles

Model
8652.1

Table of contents

1	About these instructions for use	3
1.1	Target groups	3
1.2	Labelling of notes	3
1.3	About this translated version	4
2	Product information	5
2.1	Intended use	5
2.1.1	Areas of application	5
2.2	Product description	5
2.2.1	Overview	5
3	Handling	7
3.1	Assembly information	7
3.1.1	Installation dimensions	7
3.2	Assembly	8
3.2.1	Mounting the flush plate	8
3.2.2	Install actuating rods	23
3.2.3	Disassembling the flush plate for maintenance	26
3.3	Disposal	27

1 About these instructions for use

Trade mark rights exist for this document; for further information, go to viega.com/legal.

1.1 Target groups

The information in this instruction manual is directed at the following groups of people:

- Heating and plumbing experts and trained personnel
- Drywall builders
- Tilers

Individuals without the abovementioned training or qualification are not permitted to mount, install and, if required, maintain this product. This restriction does not extend to possible operating instructions.

The installation of Viega products must take place in accordance with the general rules of engineering and the Viega instructions for use.

1.2 Labelling of notes

Warning and advisory texts are set aside from the remainder of the text and are labelled with the relevant pictographs.



DANGER!

This symbol warns of possible life-threatening injury.



WARNING!

This symbol warns of possible serious injury.



CAUTION!

This symbol warns of possible injury.



NOTICE!

This symbol warns of possible damage to property.



This symbol gives additional information and hints.

1.3 About this translated version

This instruction for use contains important information about the choice of product or system, assembly and commissioning as well as intended use and, if required, maintenance measures. The information about the products, their properties and application technology are based on the current standards in Europe (e.g. EN) and/or in Germany (e.g. DIN/DVGW).

Some passages in the text may refer to technical codes in Europe/Germany. These should serve as recommendations in the absence of corresponding national regulations. The relevant national laws, standards, regulations, directives and other technical provisions take priority over the German/European directives specified in this manual: The information herein is not binding for other countries and regions; as said above, they should be understood as a recommendation.

2 Product information

2.1 Intended use

2.1.1 Areas of application

The WC flush plate is suitable for tile-level installation in all Prevista concealed cisterns in wet and dry construction. The surface is tileable with a wall tile provided on-site.

2.2 Product description

2.2.1 Overview

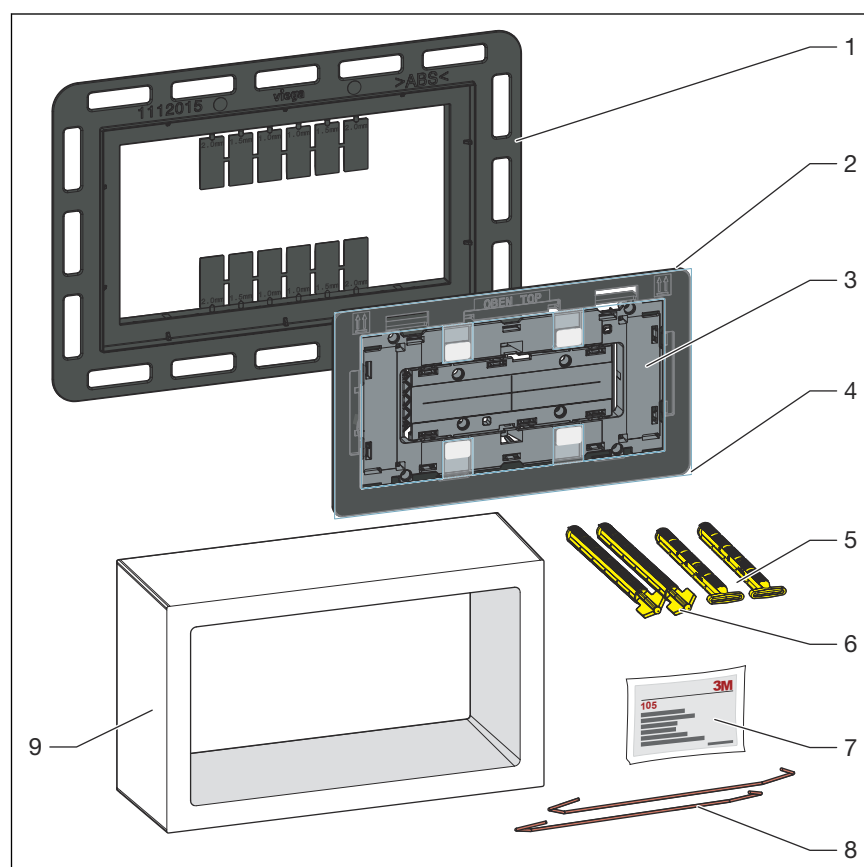

Fig. 1: Overview

- 1 Base frame
- 2 installation frame
- 3 Holder panel
- 4 Protective cover
- 5 Fixing bolts
- 6 Actuating rods

- 7 Cleaning cloth
- 8 Dismantling tool
- 9 Polystyrene frame

3 Handling

3.1 Assembly information

3.1.1 Installation dimensions

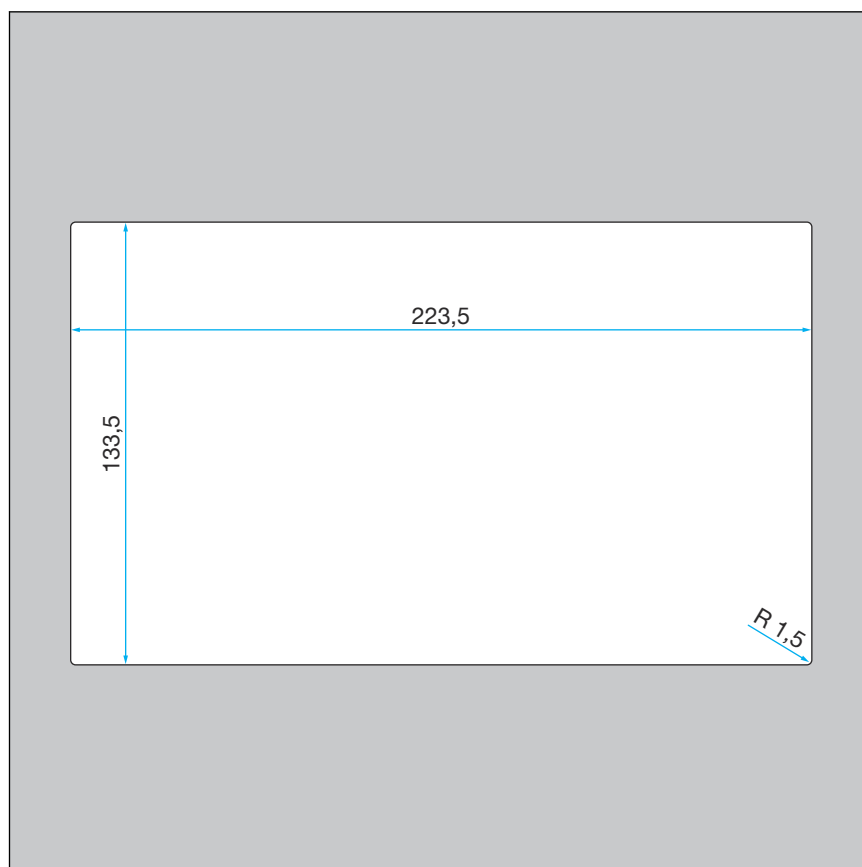

Fig. 2: Tile cutout dimensions

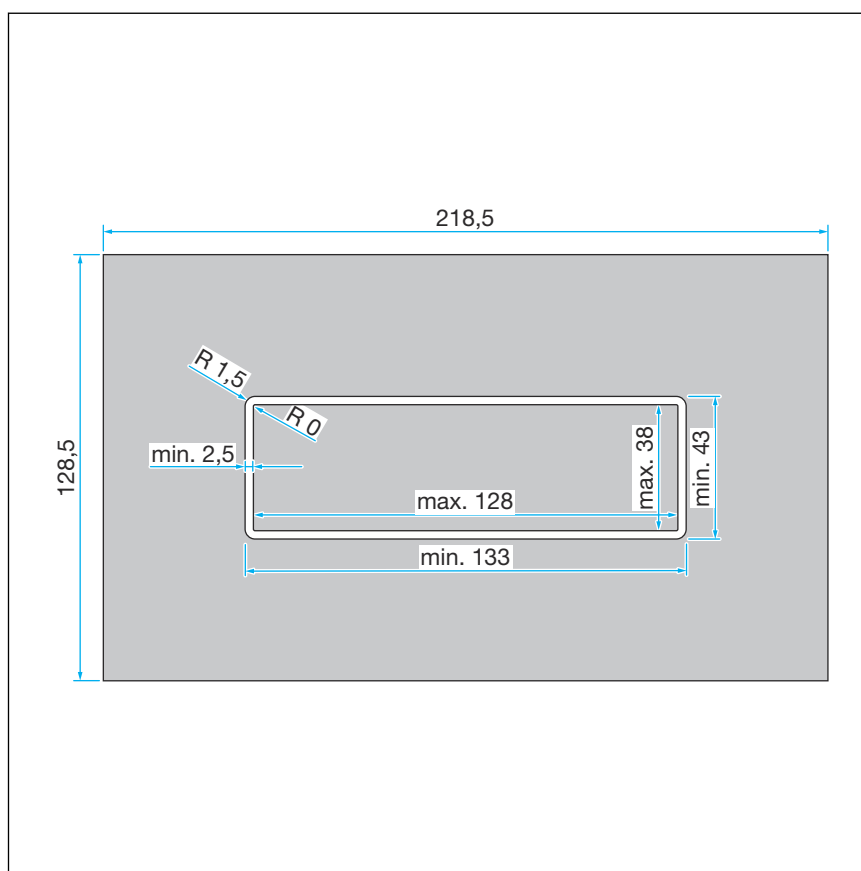

Fig. 3: Tile/flush plate dimensions

3.2 Assembly

3.2.1 Mounting the flush plate

Requirements:

- The cistern is fitted into the pre-wall.
- The inner tiles and the tile for the inspection shaft are cut to size.



To cut the tiles to size, Viega recommends water jet cutting.

Dry construction

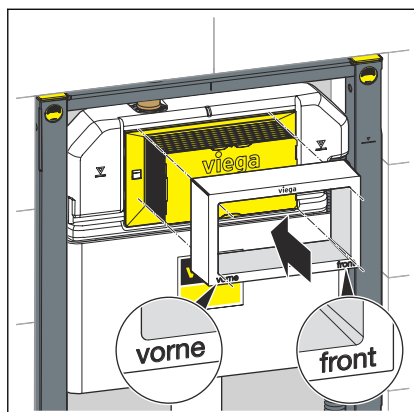

► Place the polystyrene frame on the inspection shaft.

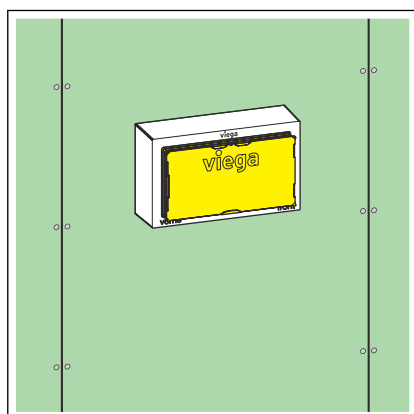

► Cover the WC element with suitable plasterboard cladding panels.

Wet construction

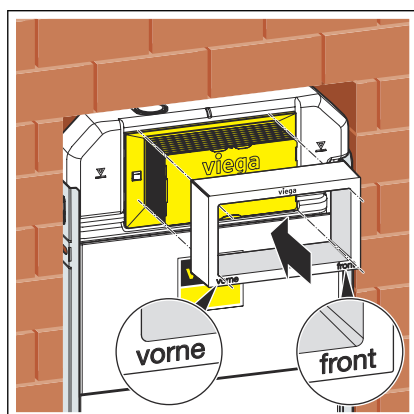

► Place the polystyrene frame on the inspection shaft.

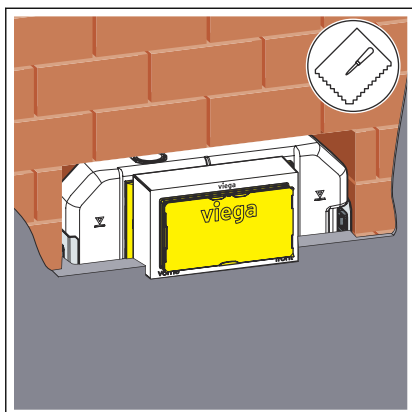

► Plaster the WC block.

Option 1: Start with the first tile on the cistern

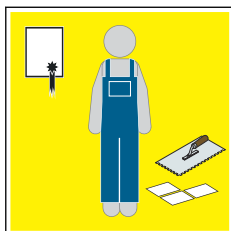

The following steps may only be carried out by tilers.

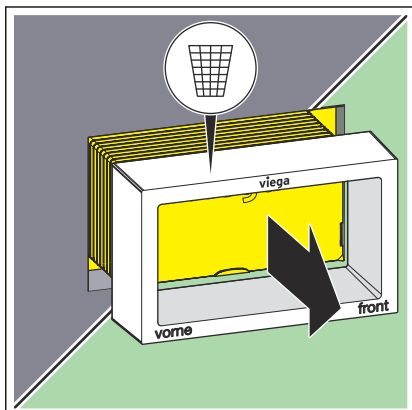

➤ Remove the polystyrene frame.

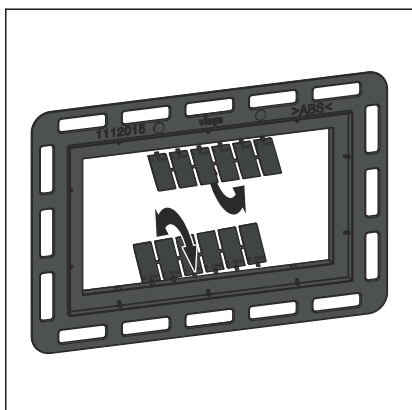

➤ Break the spacers out of the base frame.

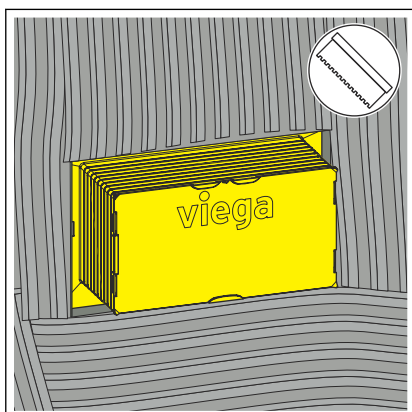

➤ Apply the tile adhesive to the pre-wall.

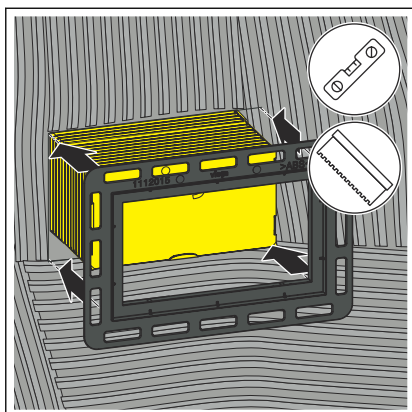

- Insert the base frame into the clearance zone of the polystyrene frame. Ensure that the base frame is centred horizontally and vertically above the inspection shaft.
- Mortar in the base frame.

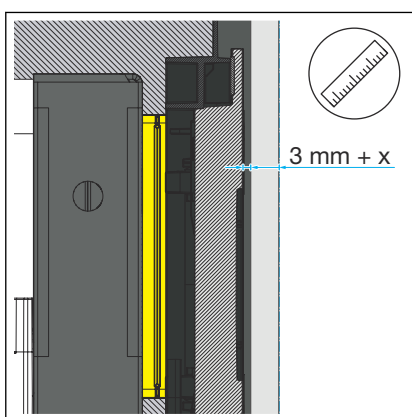

- Apply the tile adhesive so that the adhesive is at least 3 mm thick after the tile has been affixed.

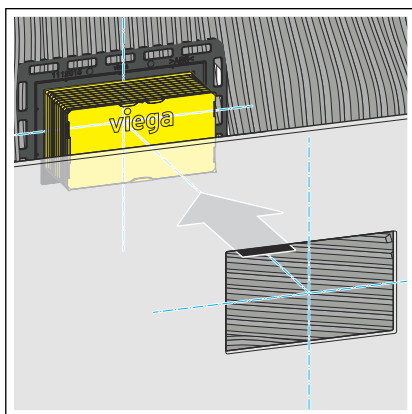

- Place the tile around the inspection shaft as the first tile on the wall.

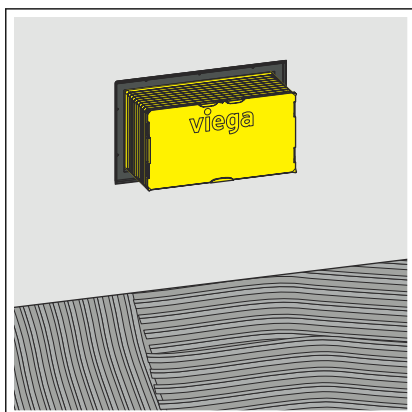

- The base frame and the first tile have been installed.

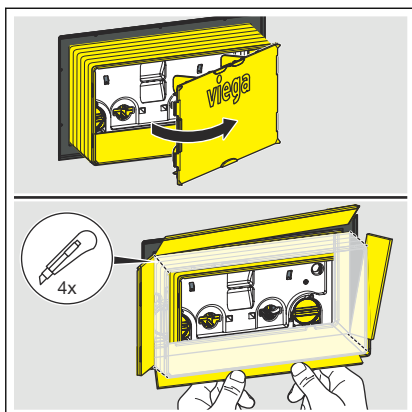

- Remove the shaft cover.
- Cut into the corners of the inspection shaft.
- Fold the sides of the inspection shaft outwards up to the base frame and snap them off.

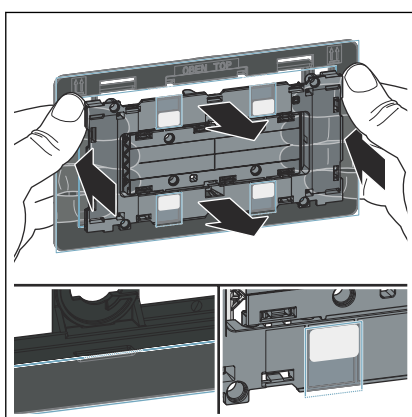

- Release the holder panel from the installation frame.
- Ensure that the protective cover remains intact at the breakthroughs.

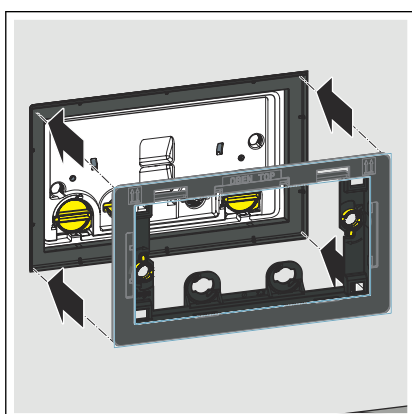

- Place the installation frame on the base frame.

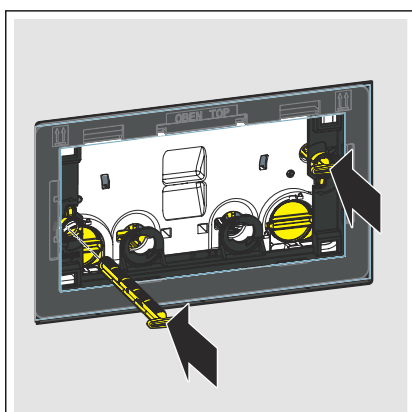

- Insert the retaining bolts.

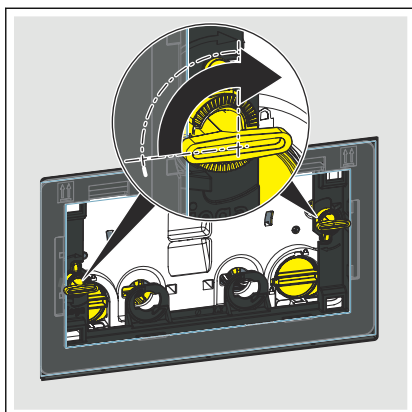

- Turn the retaining bolts by 90° in a clockwise direction.
- Align the installation frame.

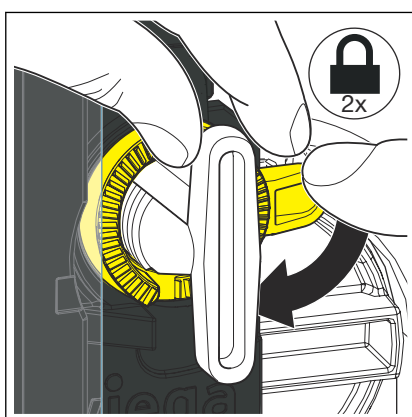

- Hold the retaining pins in their current position with one hand.
- To fasten the retaining bolts, turn the safety rings in a clockwise direction.

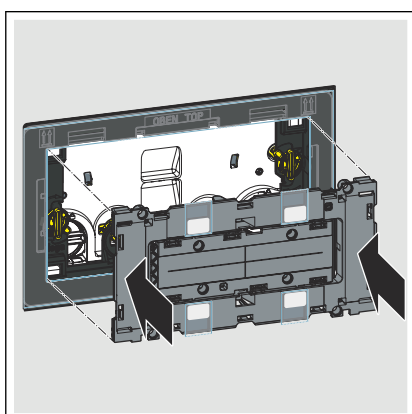

- Insert the holder panel.

NOTICE! Ensure that the protective cover is correctly positioned on the holder panel.

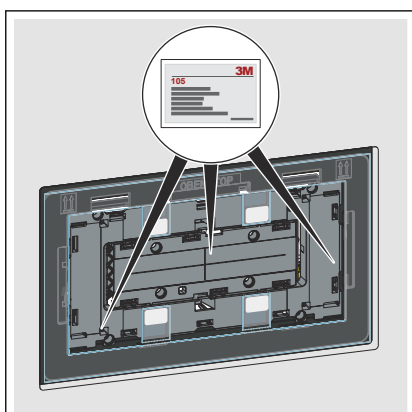

- Clean the adhesive surfaces with the cleaning cloth (included in the scope of delivery).

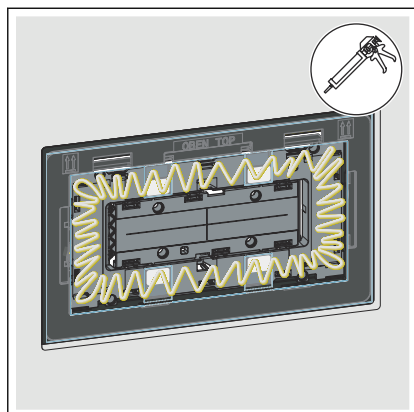

- Apply the adhesive for the outside inner tile.

NOTICE! The mounting adhesive must be suitable for the tiles and ABS plastic. Do not use silicone.

NOTICE! The outer installation frame with the factory-fitted protective cover must not come into contact with the adhesive.

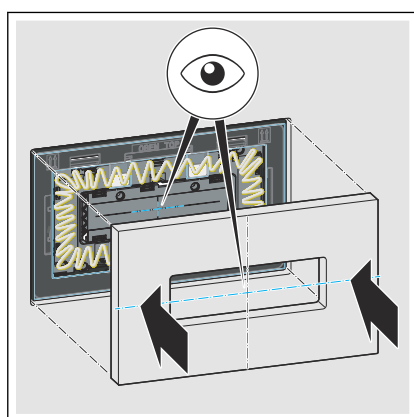

- Place the outside inner tile flush with the outer holder panel.

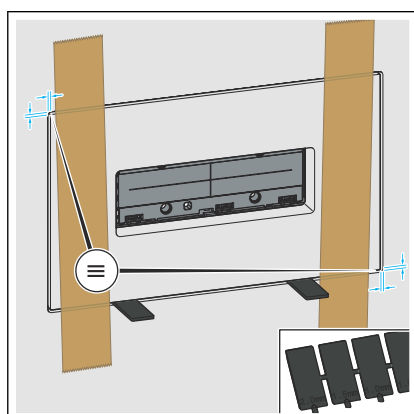

- Align the tile with the spacers.
- To avoid displacement during the drying time, fix the inner tile to the outer tile with adhesive strips.

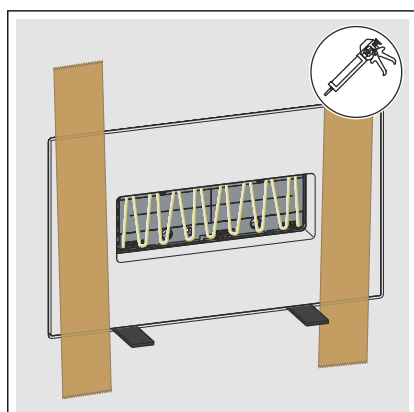

- Apply the adhesive for the tile to the pressure piece.

NOTICE! The mounting adhesive must be suitable for the tiles and ABS plastic. Do not use silicone.

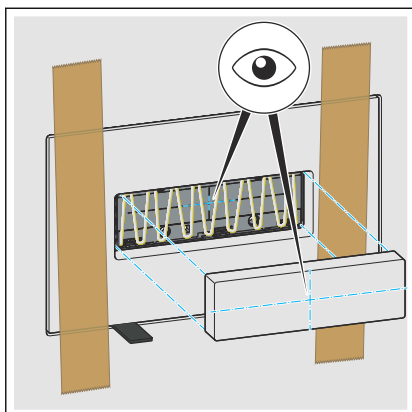

- Place the inside inner tile on the inner holder panel.

INFO! The two inner tiles must be flush with each other.

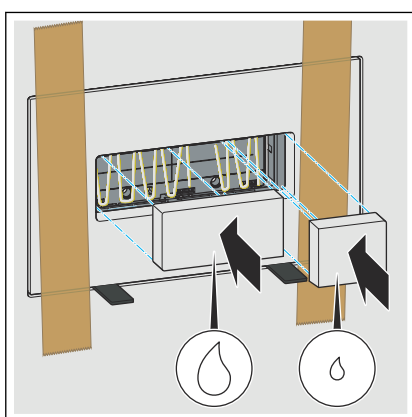

INFO! It is optionally possible to represent the large and small flush volume by differently sized tile pieces.

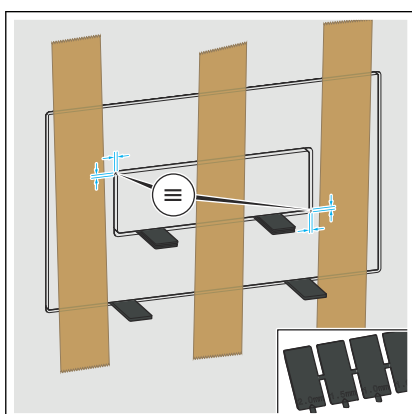

- Align the inner tile with the spacers.
- To avoid displacement during the drying time, fix the inner tile to the outer tile with adhesive strips.

Option 2: End with the last tile on the cistern

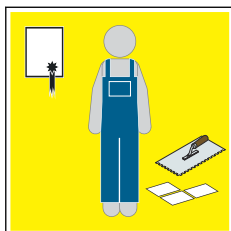

The following steps may only be carried out by tilers.

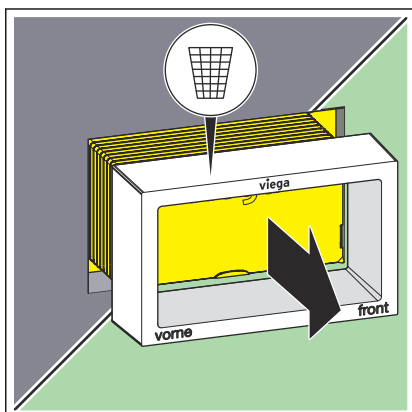

➤ Remove the polystyrene frame.

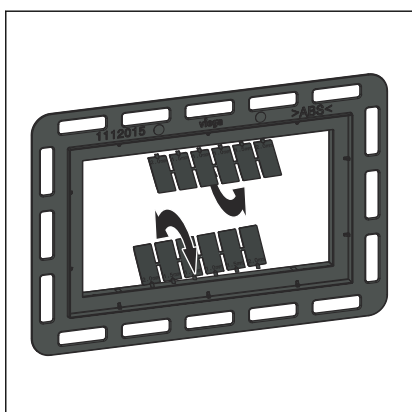

➤ Break the spacers out of the base frame.

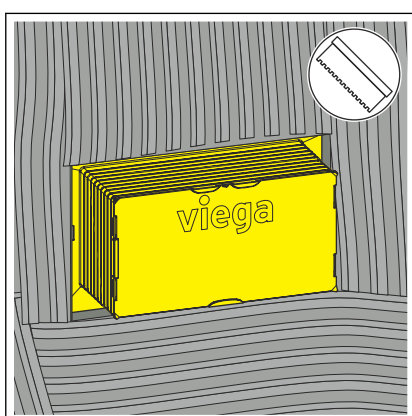

➤ Apply the tile adhesive to the pre-wall.

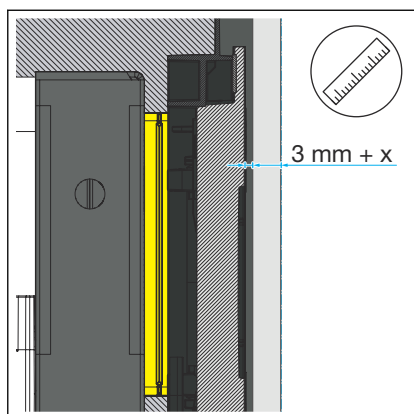

- Apply the tile adhesive so that the adhesive is at least 3 mm thick after the tile has been affixed.

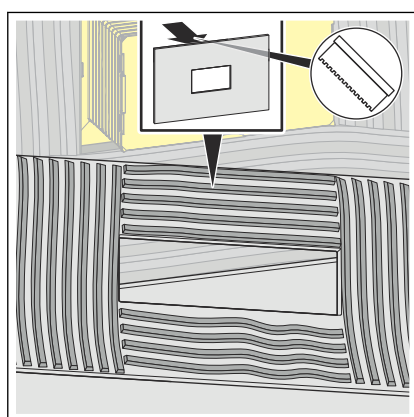

- Apply the tile adhesive to the back of the tile.

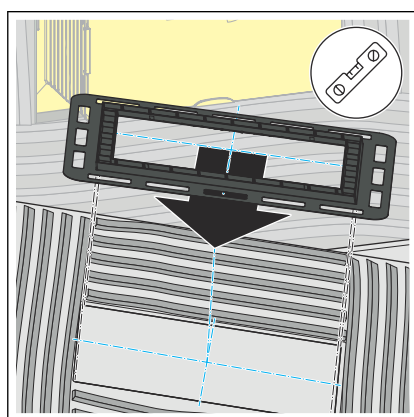

- Insert the base frame into the tile from behind.

NOTICE! Observe the correct mounting direction: The Viega lettering must point towards the tile.



- Place the tile with the base frame around the inspection shaft.

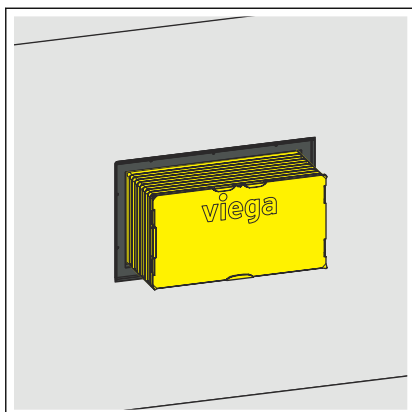

□ The base frame has been installed.

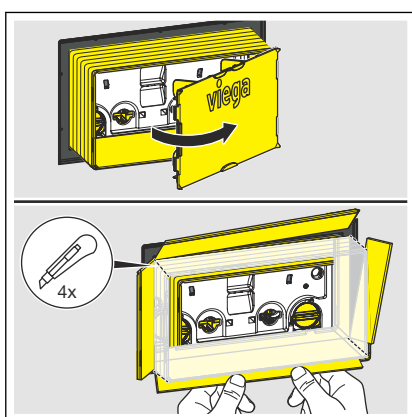

NOTICE! Do not carry out the following steps until the tile adhesive has dried.

- Remove the shaft cover.
- Cut into the corners of the inspection shaft.
- Fold the sides of the inspection shaft outwards up to the base frame and snap them off.

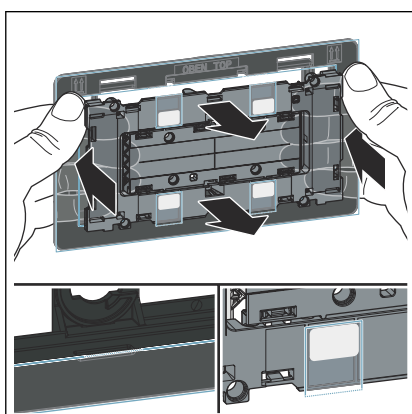

- Release the holder panel from the installation frame.
- Ensure that the protective cover remains intact at the breakthroughs.

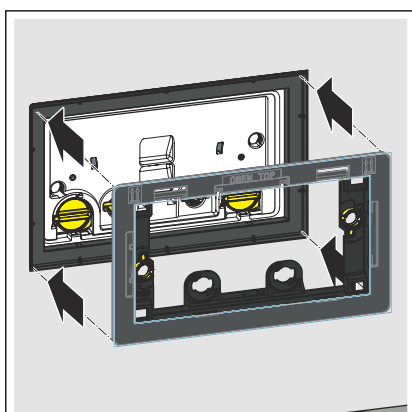

- Place the installation frame on the base frame.

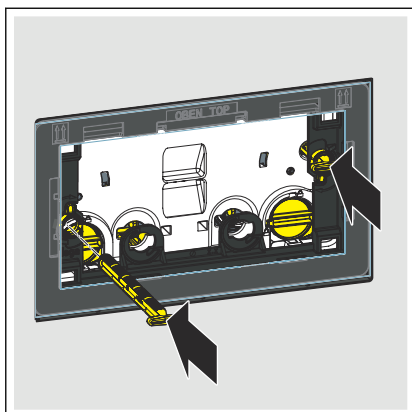

- Insert the retaining bolts.

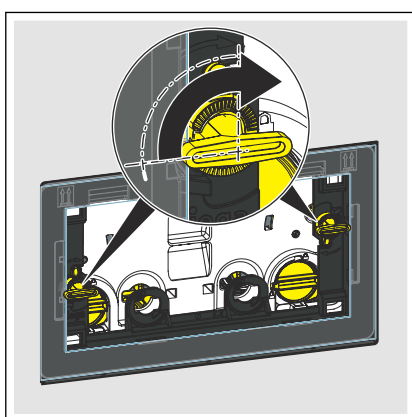

- Turn the retaining bolts by 90° in a clockwise direction.
- Align the installation frame.

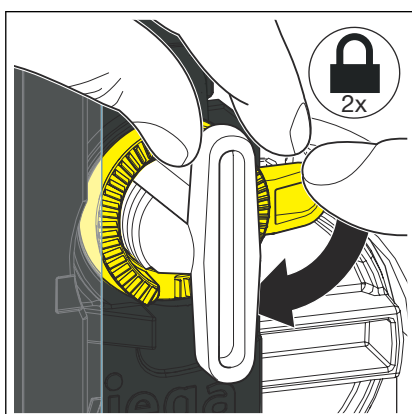

- Hold the retaining pins in their current position with one hand.
- To fasten the retaining bolts, turn the safety rings in a clockwise direction.

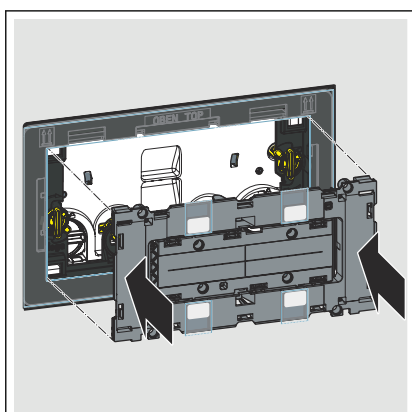

- Insert the holder panel.

NOTICE! Ensure that the protective cover is correctly positioned on the holder panel.

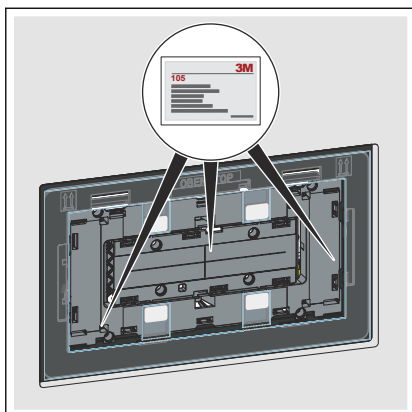

- Clean the adhesive surfaces with the cleaning cloth (included in the scope of delivery).

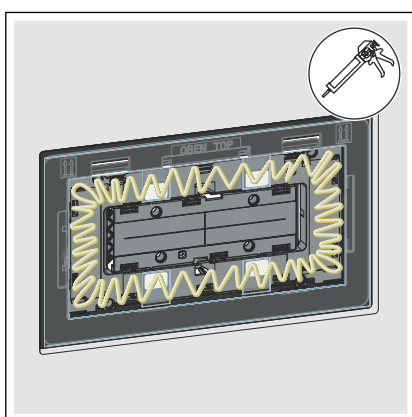

- Apply the adhesive for the outside inner tile.

NOTICE! The mounting adhesive must be suitable for the tiles and ABS plastic. Do not use silicone.

NOTICE! The outer installation frame with the factory-fitted protective cover must not come into contact with the adhesive.

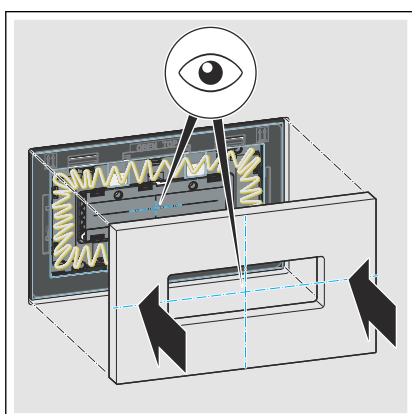

- Place the outside inner tile flush with the outer holder panel.

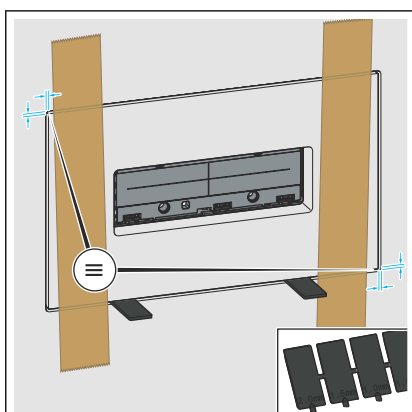

- Align the inner tile with the spacers.
- To avoid displacement during the drying time, fix the inner tile to the outer tile with adhesive strips.

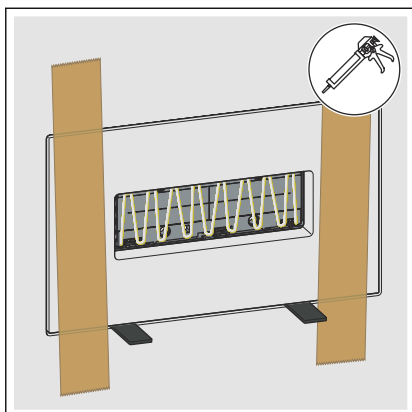

- Apply the adhesive for the inside inner tile.

NOTICE! The mounting adhesive must be suitable for the tiles and ABS plastic. Do not use silicone.

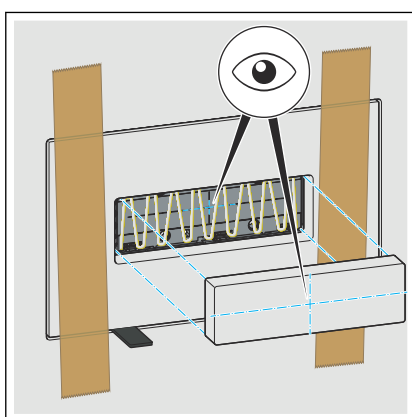

- Place the inside inner tile on the inner holder panel.

INFO! The two inner tiles must be flush with each other.

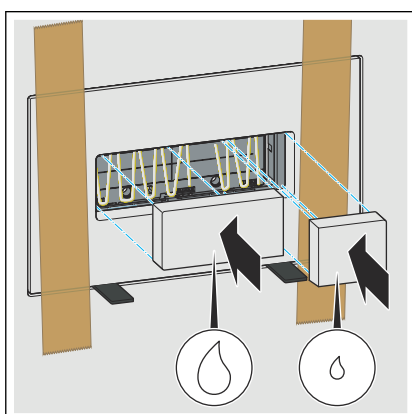

INFO! It is optionally possible to represent the large and small flush volume by differently sized tile pieces.

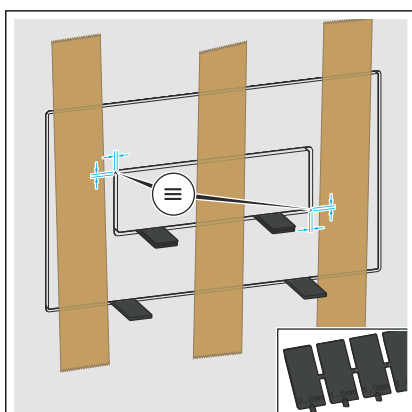

- Align the inner tile with the spacers.
- To avoid displacement during the drying time, fix the inner tile to the outer tile with adhesive strips.

3.2.2 Install actuating rods

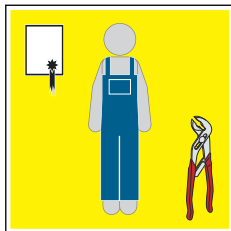

The following steps may only be carried out by plumbers.

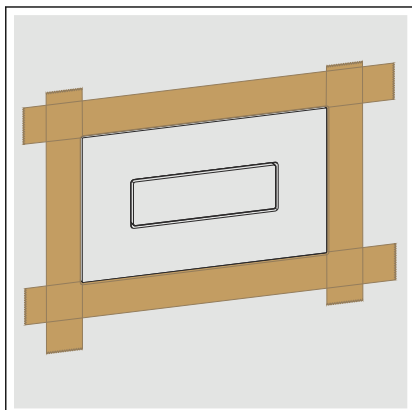

► To protect the outside tile, line the gap with masking tape.

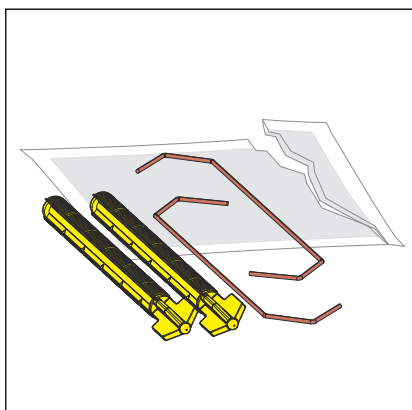

► Remove the disassembly tool and the actuating pins from the separate bag.

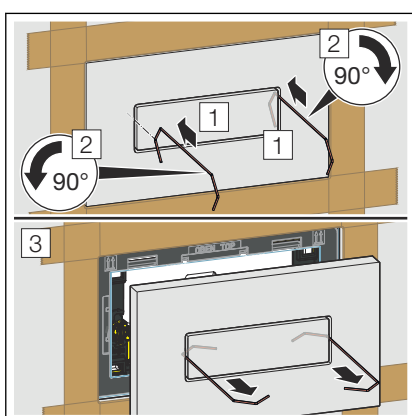

► Insert the two hooks vertically into the gap between the two inner tiles.

► Turn the two hooks inwards by 90°.

► Pull out the actuator plate.

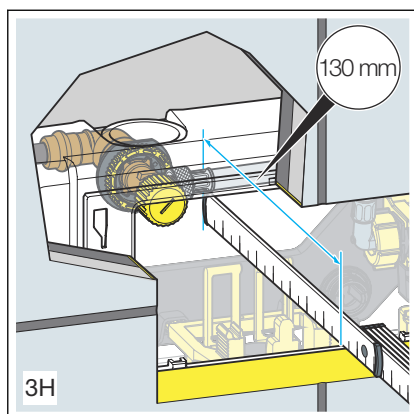

If you are not sure which cistern is installed, identify it by means of the following dimensions.

- 3H concealed cistern

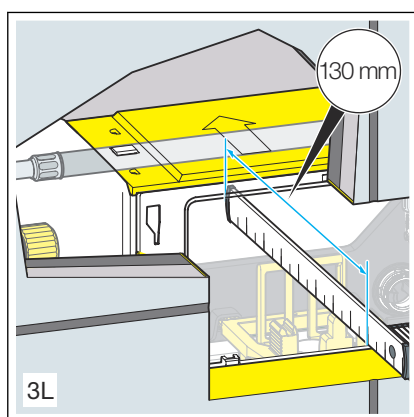

- Concealed cistern 3L

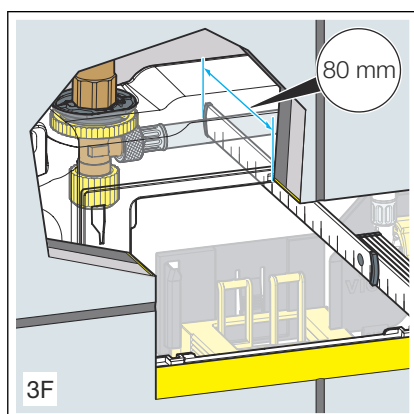

- Concealed cistern 3F

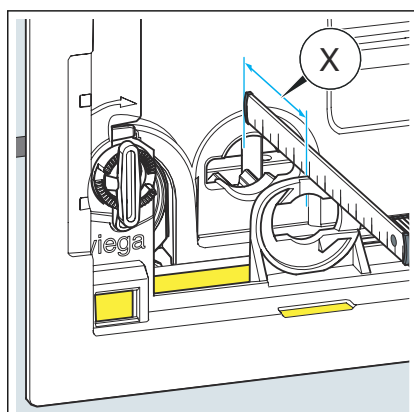

INFO! For installation from the front into the concealed cisterns 3H, 3L, 3F.

- Determine the distance for the actuating rods.

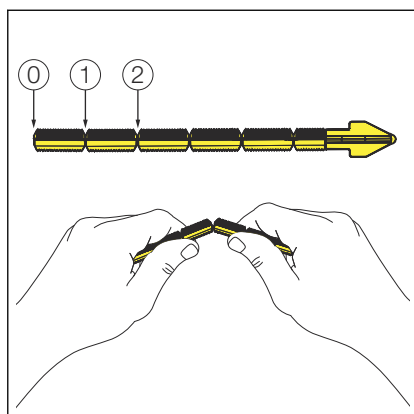

INFO! Cistern 3H and 3L.

► If necessary, cut the actuating rods to length.

- 0: 75–50 mm
- 1: 50–25 mm
- 2: 25–10 mm

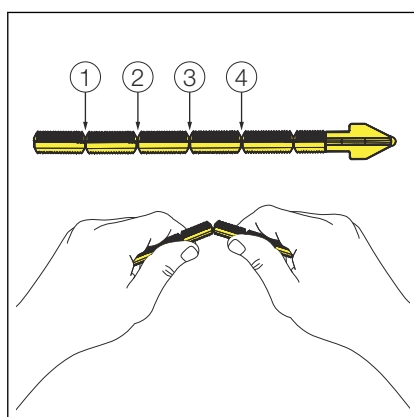

INFO! Cistern 3F.

► If necessary, cut the actuating rods to length.

- 1: 75–55 mm
- 2: 55–35 mm
- 3: 35–15 mm
- 4: 15–10 mm

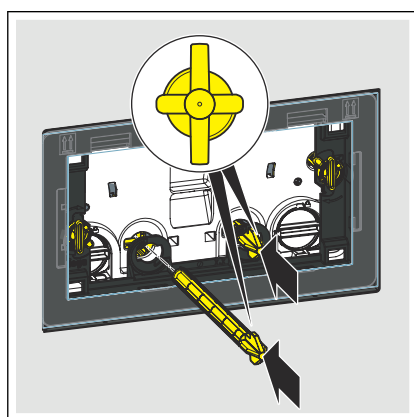

► Insert the actuating rods as far as they will go.

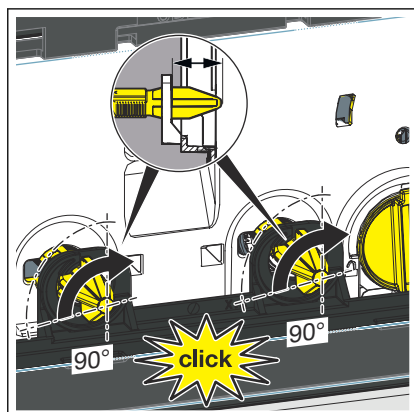

► Align the actuating rods.

► Rotate the actuating rods 90° in clockwise direction.

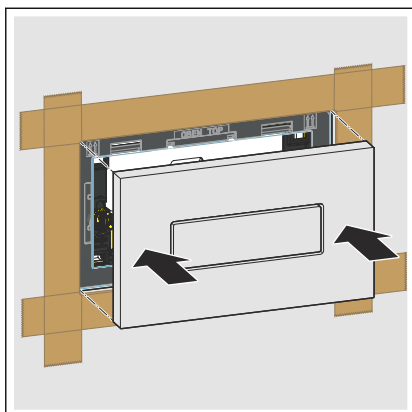

➤ Insert the flush plate again.

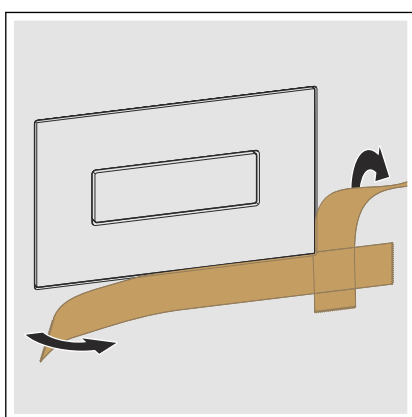

➤ Remove the masking tape.

3.2.3 Disassembling the flush plate for maintenance

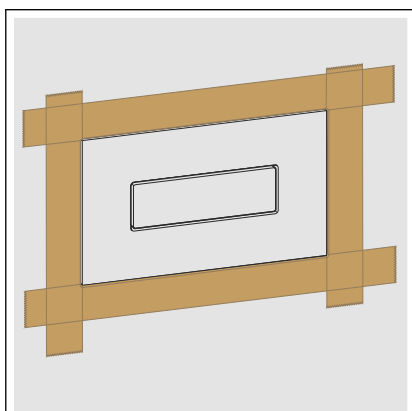

➤ To protect the outside tile, line the gap with masking tape.

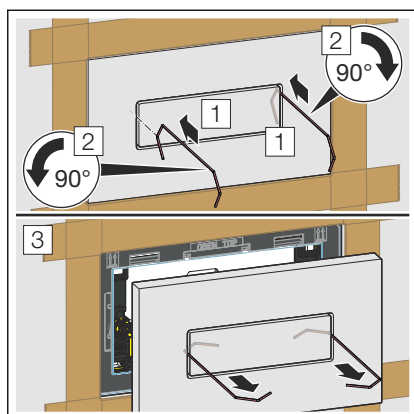

- Insert the two hooks vertically into the gap between the two inner tiles.
- Turn the two hooks inwards by 90°.
- Pull out the actuator plate.

3.3 Disposal

Separate the product and packaging materials (e. g. paper, metal, plastic or non-ferrous metals) and dispose of in accordance with valid national legal requirements.



Viega GmbH & Co. KG
service-technik@viega.de
viega.com

INT • 2025-10 • VPN250188

