

# **Domoplex standpipe**

## **Instructions for Use**



**Model**  
6928.5

**en\_INT**

**Year built:**  
from 01/2002

**viega**



# Table of contents

<b>1</b>	<b>About these instructions for use</b>	<b>4</b>
1.1	Target groups	4
1.2	Labelling of notes	4
1.3	About this translated version	5
 <b>2</b>	 <b>Product information</b>	 <b>6</b>
2.1	Intended use	6
2.1.1	Areas of use	6
2.2	Product description	6
2.2.1	Overview	6
2.2.2	Technical data	7
 <b>3</b>	 <b>Handling</b>	 <b>8</b>
3.1	Assembly information	8
3.1.1	Mounting conditions	8
3.1.2	Installation dimensions	8
3.2	Assembly	8
3.2.1	Standpipe mounting	8
3.2.2	Leakage test	9
3.3	Maintenance	9
3.4	Cleaning the drain	10
3.5	Disposal	10

# 1 About these instructions for use

Trade mark rights exist for this document, further information can be found at [www.viega.com/legal-notice](http://www.viega.com/legal-notice).

## 1.1 Target groups

The information in this instruction manual is directed at the following groups of people:

- Heating and sanitary professionals and trained personnel
- Operators
- Consumers

It is not permitted for individuals without the abovementioned training or qualification to mount, install and, if required, service this product. This restriction does not extend to possible operating instructions.

The installation of Viega products must take place in accordance with the general rules of engineering and the Viega instructions for use.

## 1.2 Labelling of notes

Warning and advisory texts are set aside from the remainder of the text and are labelled with the relevant pictographs.



### **DANGER!**

This symbol warns against possible life-threatening injury.



### **WARNING!**

This symbol warns against possible serious injury.



### **CAUTION!**

This symbol warns against possible injury.



### **NOTICE!**

This symbol warns against possible damage to property.



*Notes give you additional helpful tips.*

### **1.3 About this translated version**

This instruction for use contains important information about the choice of product or system, assembly and commissioning as well as intended use and, if required, maintenance measures. The information about the products, their properties and application technology are based on the current standards in Europe (e. g. EN) and/or in Germany (e. g. DIN/DVGW).

Some passages in the text may refer to technical codes in Europe/Germany. These should serve as recommendations in the absence of corresponding national regulations. The pertinent national laws, standards, regulations and guidelines, as well as other technical guidelines, have priority over German/European guidelines in this manual: The information is not binding for other countries and territories and should, as mentioned, be considered as support.

## 2 Product information

### 2.1 Intended use

#### 2.1.1 Areas of use



#### NOTICE!

#### Risk of damage due to unsuitable liquids.

To avoid damaging the drain, only introduce the following liquids:

- Liquids with a pH-value higher than 4
- typical household water with a maximum temperature of 95 °C

The Domoplex standpipe is a chrome-plated drainpipe for shower trays with a 52 mm drain hole. The Domoplex standpipe enables the increase in the maximum water level in the shower tray by about 10 cm.

Detailed information regarding all shower tray models and the corresponding Viega drains can be found in the catalogue or on the Internet.

### 2.2 Product description

#### 2.2.1 Overview

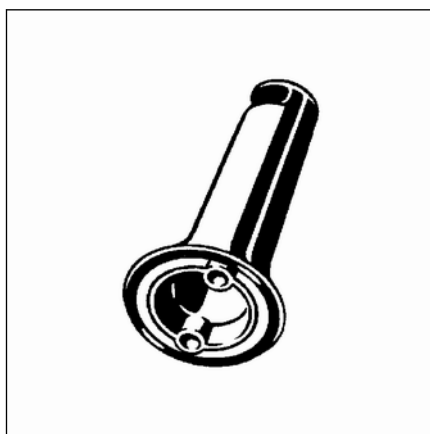

Fig. 1: Domoplex standpipe with internal seal

The Domoplex standpipe is delivered with a pre-mounted internal seal.

## 2.2.2 Technical data

Height	110 mm
Dimensions and installation depth	↪ <i>Chapter 3.1.2 „Installation dimensions“ on page 8</i>
Water level	100 mm

## 3 Handling

### 3.1 Assembly information

#### 3.1.1 Mounting conditions

The following requirements exist for the mounting of the Domoplex stand pipe:

- The shower tray is installed.
- The drainage line is installed all the way to the shower tray.
- A Domoplex drain is installed.
- The wastewater system is connected.

#### 3.1.2 Installation dimensions

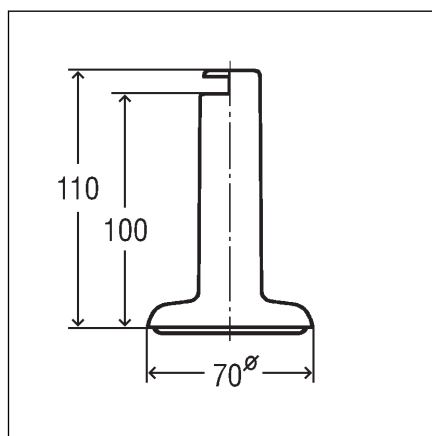

Fig. 2: Dimensional drawing

### 3.2 Assembly

#### 3.2.1 Standpipe mounting



*The Domoplex standpipe can only be mounted on a Domoplex drain.*



Requirements:

- If a cover plate is fitted, you first have to remove the cover plate.
- Remove cover plate.

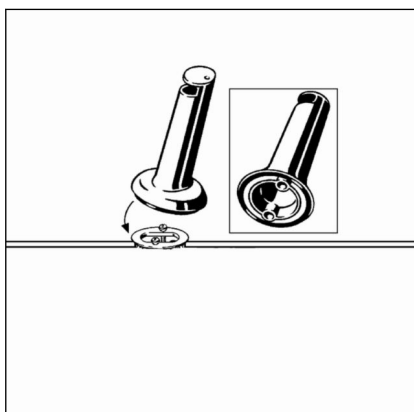
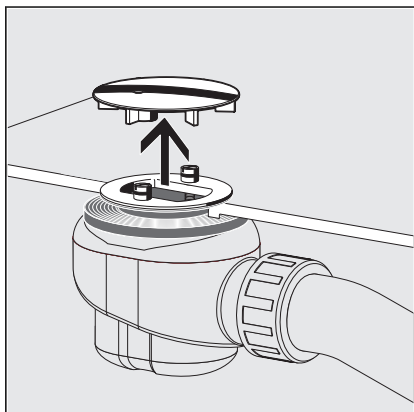

- Press Domoplex standpipe onto the two fixing screws.

### 3.2.2 Leakage test

The leakage test is only carried out as a visual inspection.

- Check drain fitting for visible leaks.

## 3.3 Maintenance



#### NOTICE!

**Risk of damage due to unsuitable cleaning agent.**

The following cleaning agents can damage chrome-plated surfaces and therefore may not be used:

- scouring agent
- abrasive sponges
- lime, plaster or cement dissolver
- solvents or other acidic cleaning agents

Normal soap or a mild cleaning agent can be used for regular care and prevention of lime scale on the rotatable rosette and valve cone. Under no circumstances should scouring agent or scratching objects be used.

Strong stains, even around the drain unit and the siphon, can be removed using typical household cleaner. It should be noted that the cleaning agent should be rinsed off after the prescribed soaking time. There should be no residue on the components.

## 3.4 Cleaning the drain



### NOTICE!

Be careful not to damage the odour trap when cleaning the drain system.

**INFO! The Domoplex shower drains are available in various versions. Therefore, observe the instructions for use of your shower drain for the following steps.**

- Domoplex, remove standpipe.
- Remove the immersion pipe upwards.
- If a closing plug is present, remove the closing plug for free access to the drain pipe.
- Clean the drain carefully to avoid damaging the fitting.
- Re-insert the closing plug.
- Replace immersion pipe.
- Mount Domoplex standpipe.

## 3.5 Disposal

Separate the product and packaging materials (e. g. paper, metal, plastic or non-ferrous metals) and dispose of in accordance with valid national legal requirements.