

Instructions for Use

Cable bushing



suitable for WC connection box

Model
8580.67

Year built (from)
03/2023

viega

Table of contents

1	About these instructions for use	3
1.1	Target groups	3
1.2	Labelling of notes	3
1.3	About this translated version	4
2	Product information	5
2.1	Intended use	5
2.1.1	Areas of application	5
2.2	Product description	5
2.2.1	Overview	5
3	Handling	6
3.1	Assembly	6
3.1.1	Installing the cable bushing	6
3.2	Disposal	9

1 About these instructions for use

Trade mark rights exist for this document; for further information, go to viega.com/legal.

1.1 Target groups

The information in this instruction manual is directed at the following groups of people:

- Heating and plumbing experts and trained personnel
- Qualified electricians

Individuals without the abovementioned training or qualification are not permitted to mount, install and, if required, maintain this product. This restriction does not extend to possible operating instructions.

The installation of Viega products must take place in accordance with the general rules of engineering and the Viega instructions for use.

1.2 Labelling of notes

Warning and advisory texts are set aside from the remainder of the text and are labelled with the relevant pictographs.



DANGER!

This symbol warns of possible life-threatening injury.



WARNING!

This symbol warns of possible serious injury.



CAUTION!

This symbol warns of possible injury.



NOTICE!

This symbol warns of possible damage to property.



This symbol gives additional information and hints.

1.3 About this translated version

This instruction for use contains important information about the choice of product or system, assembly and commissioning as well as intended use and, if required, maintenance measures. The information about the products, their properties and application technology are based on the current standards in Europe (e.g. EN) and/or in Germany (e.g. DIN/DVGW).

Some passages in the text may refer to technical codes in Europe/Germany. These should serve as recommendations in the absence of corresponding national regulations. The relevant national laws, standards, regulations, directives and other technical provisions take priority over the German/European directives specified in this manual: The information herein is not binding for other countries and regions; as said above, they should be understood as a recommendation.

2 Product information

2.1 Intended use

2.1.1 Areas of application

The cable bushing is required if only one cable (without empty conduit) is inserted or if the power supply of a shower WC is routed through the WC connection box.

2.2 Product description

2.2.1 Overview

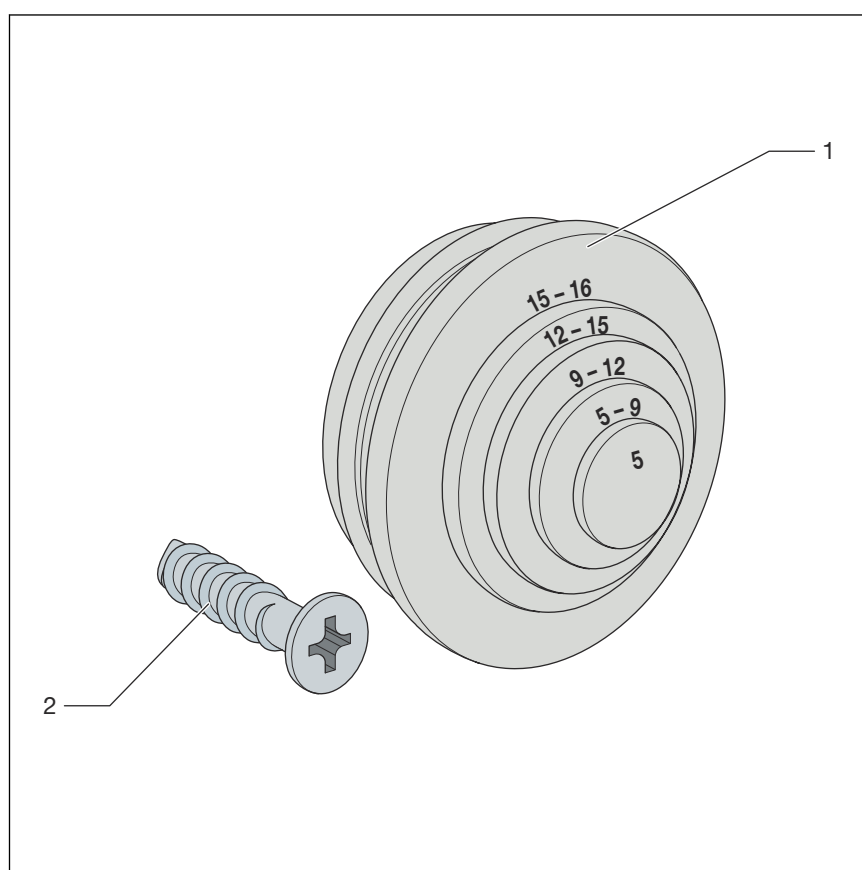

Fig. 1: Components

- 1 Cable bushing
- 2 Screw for the covering in the connection box

3 Handling

3.1 Assembly

3.1.1 Installing the cable bushing



DANGER! **Danger due to electrical current**

An electric shock can lead to burns and serious injury and even death.

- Work on the electrical system may only be carried out by trained electricians.
- When working in or on electronic systems, switch off the mains voltage and take steps to prevent accidental re-activation.

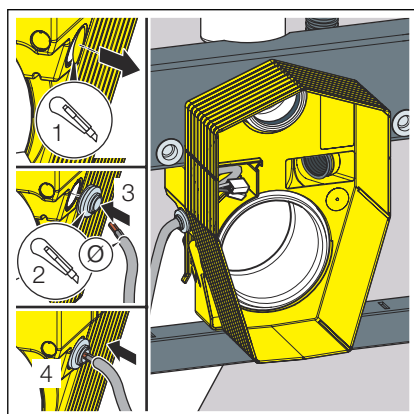

- Cut out the recess for the power supply.
- Insert the cable bushing (model 8580.67) into the recess.
- Strip the insulation from the power supply (light plastic-sheathed cable NYM-J 3x1.5 mm²) by approx. 5 cm.
- Lead the power supply (light plastic-sheathed cable NYM-J 3x1.5 mm²) approx. 5 cm into the connection box.

INFO! Make sure that the terminals are below the power pack.

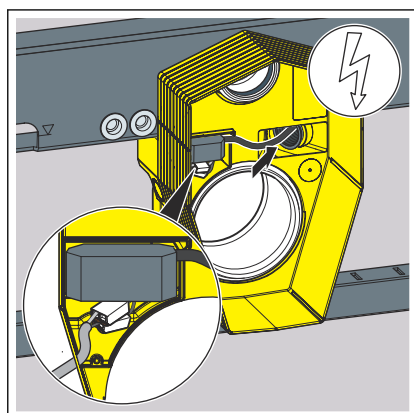

- Attach the power pack of the electronic accessory set (model 8655.11).
- Guide the power supply upwards through the empty conduit into the concealed cistern.

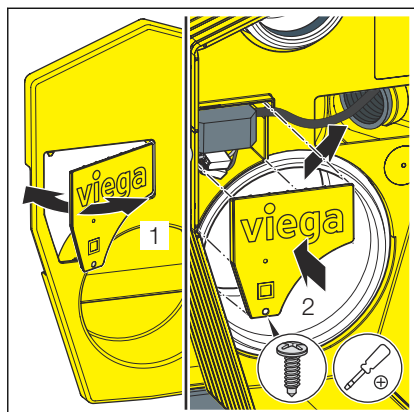

➤ Remove the covering in the cover.

➤ Close the mains adapter in the connection box with the cover and secure with the enclosed screw (3.2x15).

Additionally for connection to shower toilet

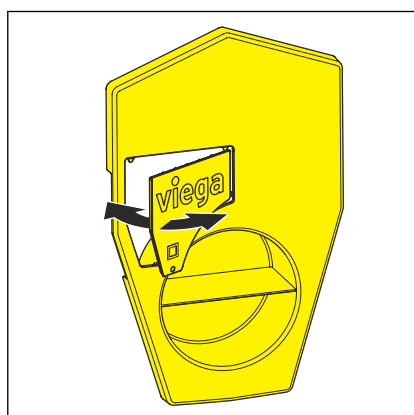

➤ Remove the covering in the cover.

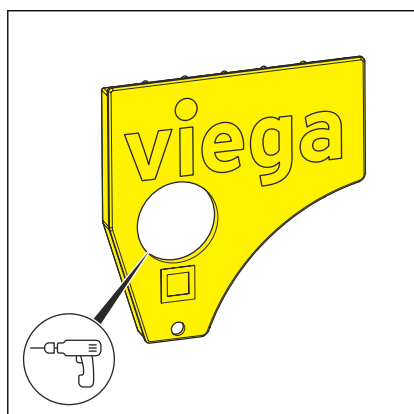

➤ Drill a hole of Ø20 mm in the covering.

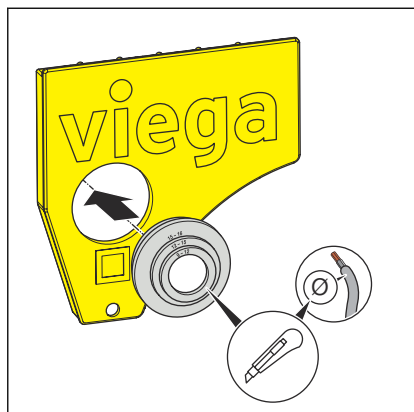

➤ Insert the cable bushing into the recess.

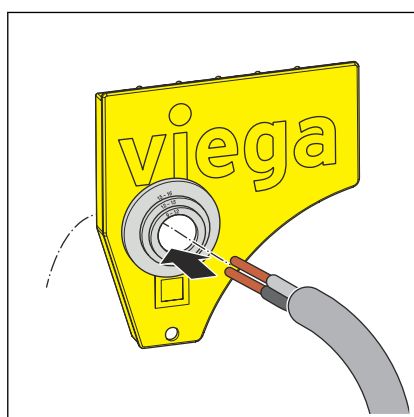

➤ Guide the cable for the shower toilet through the cable bushing.

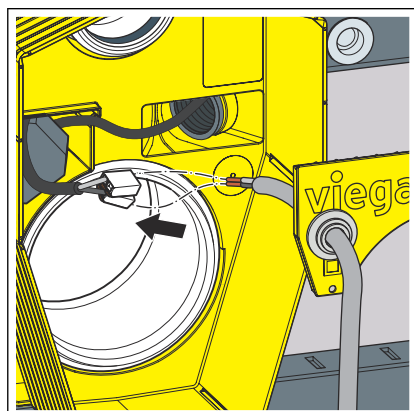

➤ Connect the cable for the shower toilet to the power supply (light plastic-sheathed cable NYM-J 3x1.5 mm²).

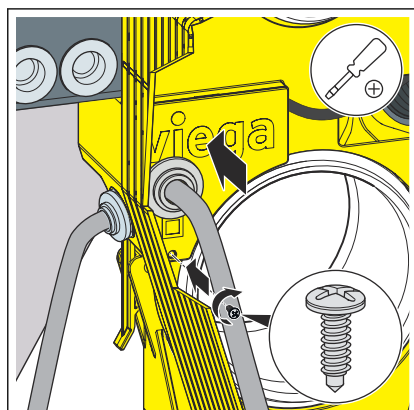

➤ Close the power pack in the connection box with the covering and screw in the screw.

Putting on the cover

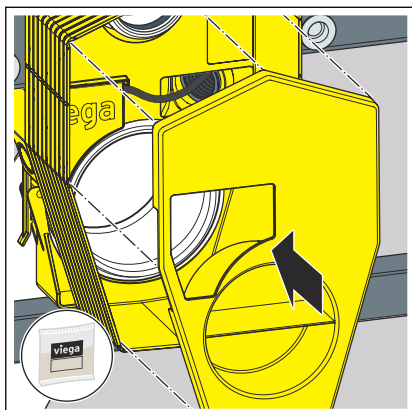

► Put the cover on the connection box.

3.2 Disposal

Separate the product and packaging materials (e. g. paper, metal, plastic or non-ferrous metals) and dispose of in accordance with valid national legal requirements.



Viega GmbH & Co. KG
service-technik@viega.de
viega.com

INT • 2024-04 • VPN240159

