

Concealed connection box Mono

Instructions for Use



For WBs with single-hole fitting, walling in and around

Model
8314

Year built:
from 08/2015

en_INT

viega

Table of contents

1	About these instructions for use	4
1.1	Target groups	4
1.2	Labelling of notes	4
1.3	About this translated version	5
2	Product information	6
2.1	Intended use	6
2.1.1	Areas of use	6
2.2	Product description	6
2.2.1	Overview	6
2.2.2	Compatible components	7
2.2.3	Technical data	7
2.3	Accessories and spare parts	8
3	Handling	9
3.1	Assembly information	9
3.1.1	Installation dimensions	9
3.1.2	Required tools and materials	9
3.2	Assembly	9
3.2.1	Preparing concealed connection box	9
3.2.2	Shell mounting of the concealed connection box	11
3.2.3	Final assembly of the concealed connection box	12
3.3	Cleaning and maintenance	15
3.4	Disposal	17

1 About these instructions for use

Trade mark rights exist for this document, further information can be found at www.viega.com/legal-notice.

1.1 Target groups

The information in this instruction manual is directed at the following groups of people:

- Heating and sanitary professionals and trained personnel

It is not permitted for individuals without the abovementioned training or qualification to mount, install and, if required, service this product. This restriction does not extend to possible operating instructions.

The installation of Viega products must take place in accordance with the general rules of engineering and the Viega instructions for use.

1.2 Labelling of notes

Warning and advisory texts are set aside from the remainder of the text and are labelled with the relevant pictographs.



DANGER!

This symbol warns against possible life-threatening injury.



WARNING!

This symbol warns against possible serious injury.



CAUTION!

This symbol warns against possible injury.



NOTICE!

This symbol warns against possible damage to property.



Notes give you additional helpful tips.

1.3 About this translated version

This instruction for use contains important information about the choice of product or system, assembly and commissioning as well as intended use and, if required, maintenance measures. The information about the products, their properties and application technology are based on the current standards in Europe (e. g. EN) and/or in Germany (e. g. DIN/DVGW).

Some passages in the text may refer to technical codes in Europe/Germany. These should serve as recommendations in the absence of corresponding national regulations. The pertinent national laws, standards, regulations and guidelines, as well as other technical guidelines, have priority over German/European guidelines in this manual: The information is not binding for other countries and territories and should, as mentioned, be considered as support.

2 Product information

2.1 Intended use

2.1.1 Areas of use

The Mono concealed connection box is suitable for the connection of washbasins with single-hole fitting and for walling in or around.

2.2 Product description

2.2.1 Overview

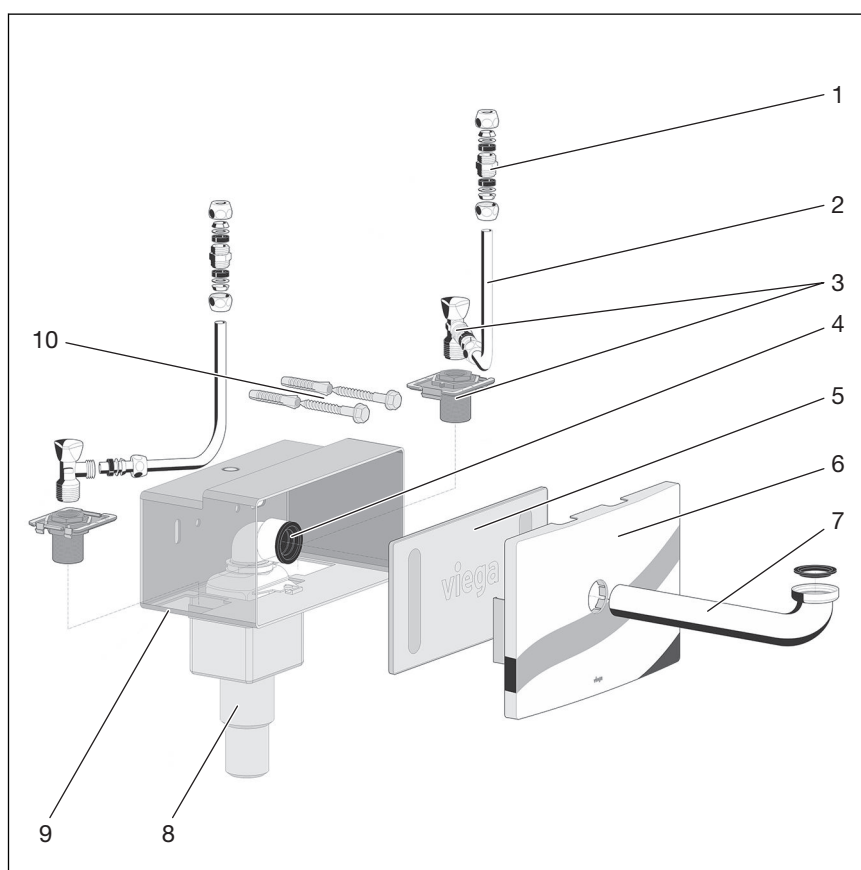

Fig. 1: Components

- 1 - Compression fitting, 10 mm
- 2 - Pipe elbow, 10 mm, chrome-plated
- 3 - Corner valve incl. wall lead-in
- 4 - Concealed odour trap
- 5 - Site protection
- 6 - Chrome-plated plastic cover plate
- 7 - Drain elbow
- 8 - Drainage connection DN 40/50
- 9 - Concealed connection box casing
- 10 - Wall fixing material

2.2.2 Compatible components

The Viega Mono concealed connection box can be combined with all standard washbasin ceramics and washbasin fittings.

2.2.3 Technical data

The product has the following technical data:

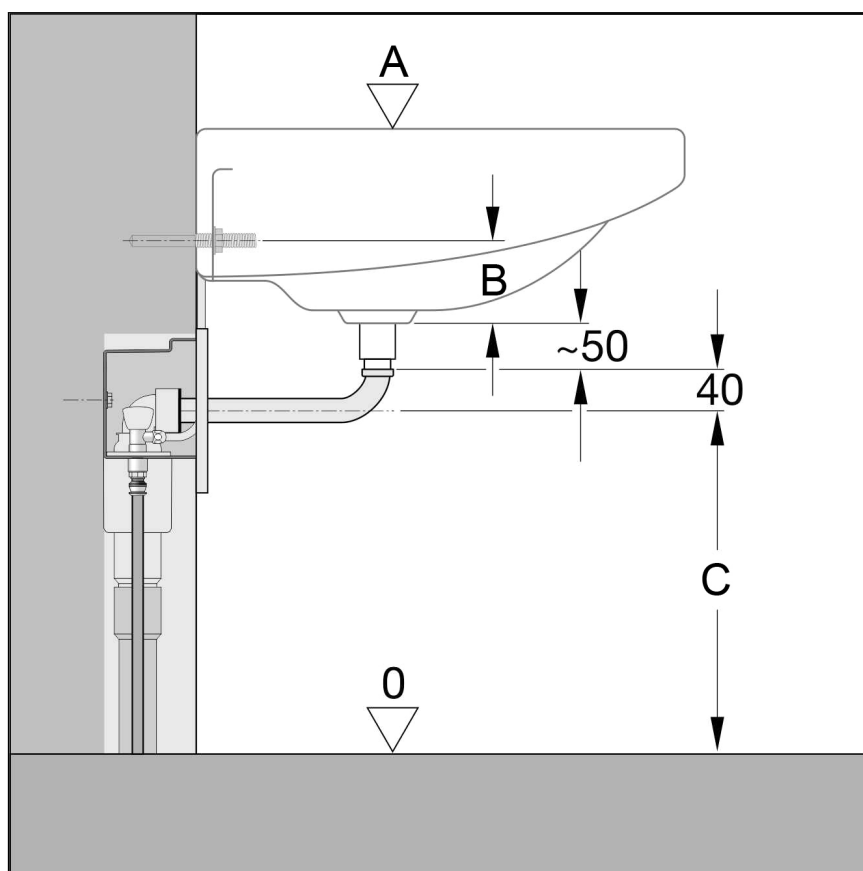

- A - 850 mm above UEFFL
- B - Observe the ceramic manufacturer's instructions
- C - Observe the ceramic manufacturer's instructions

2.3 Accessories and spare parts

Spare parts

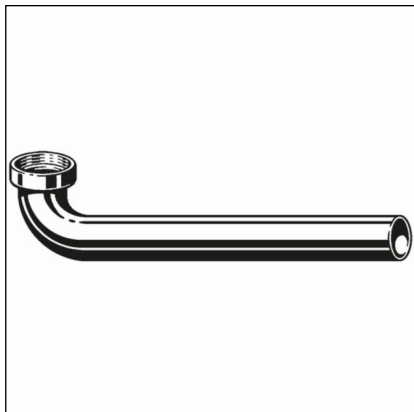

Fig. 2: drain elbow

Drain elbow, model 8064.90, art. no. 743208

- chrome-plated
- with flanged rim

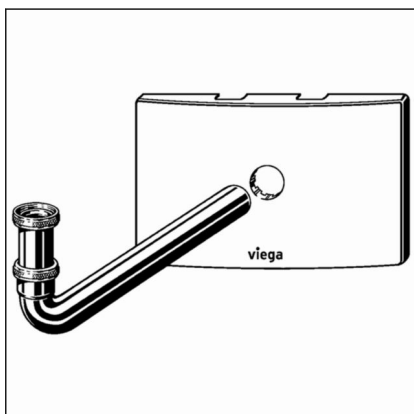

Fig. 3: Ready-to-install set

Ready-to-install set, model 8314.5, art. no. 734848, consisting of

- cover plate
- drain elbow
- drainpipe with flanged rim, 75 mm

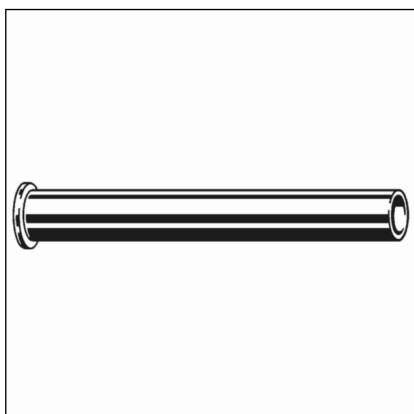

Fig. 4: drainpipe

Drainpipe, model 9945-143

- with flanged pipe
- suitable for the ready-to-install set, model 8314.5
- available in the following versions:
 - 75 mm, art. no. 121587
 - 120 mm, art. no. 670856
 - 150 mm, art. no. 670863

3 Handling

3.1 Assembly information

3.1.1 Installation dimensions

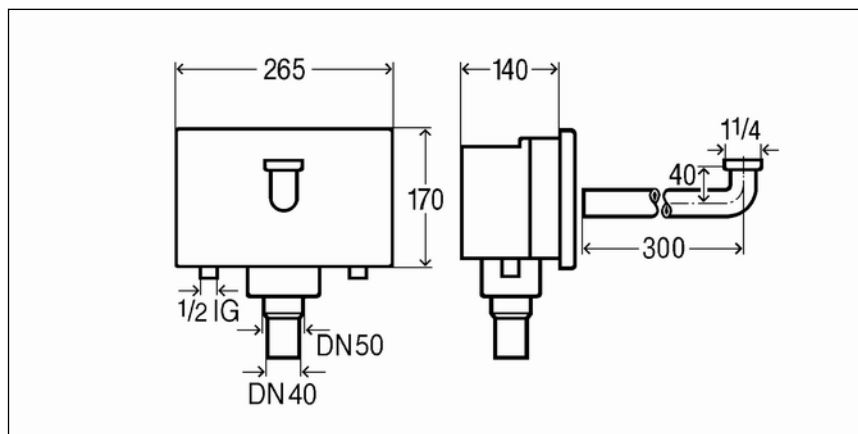

Fig. 5: Dimensional drawing

3.1.2 Required tools and materials

Required tools

The following tools are required for mounting:

- Drill with 10 mm drill bit
- Jaw or ring wrench, SW 19 and SW 27
- Ratchet with sockets: 13 mm
- Screwdriver
- Spirit level

Required material

The following tools, which are not comprised in the scope of delivery, are required for mounting:

- Material for bricking in the block
- Fittings
- Ceramic washbasin

3.2 Assembly

3.2.1 Preparing concealed connection box

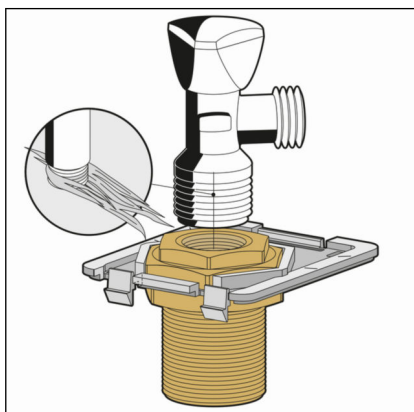

► Seal the corner valve (e.g. using hemp).

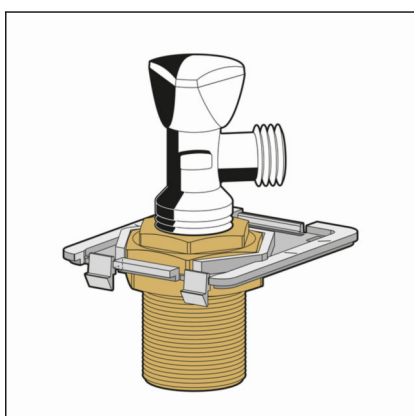

► Screw the corner valve into the screw fitting.

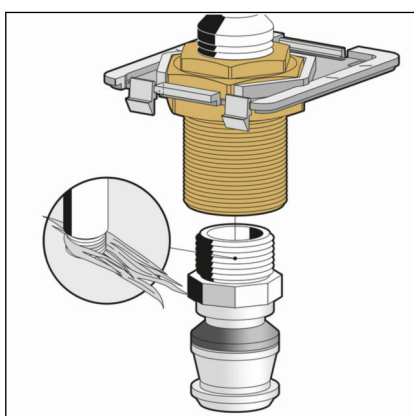

► Seal and screw in a suitable pipeline adapter.

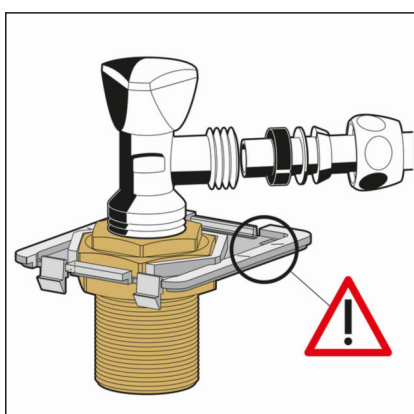

INFO! Observe the additional markings when aligning the corner valves.

► Screw in until the connection to the washbasin fitting is between the markings.

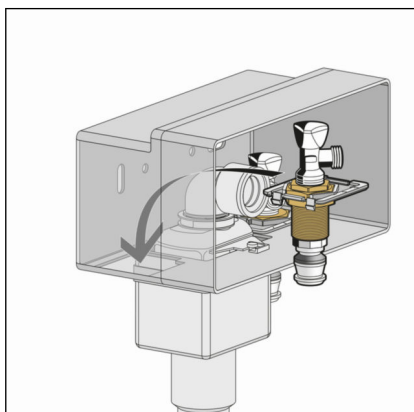

► Mount the entire seats in the concealed connection box.

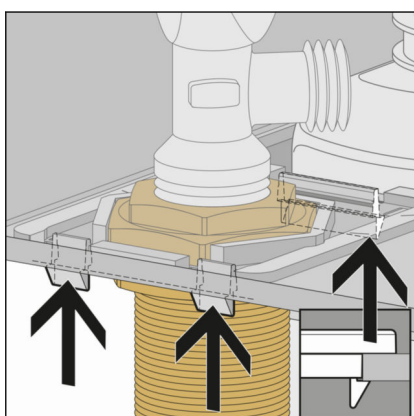

⇒ The object can be heard locking into place.

Optional cable inlet

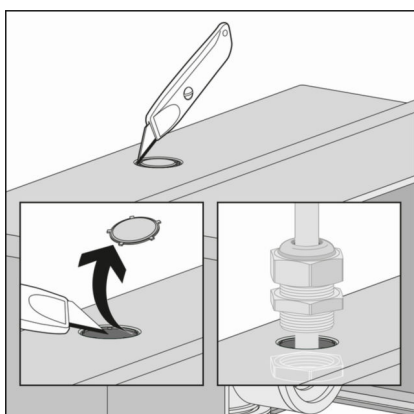

INFO! On the top of the concealed connection box a section can be cut out which, for example, can be used as a cable passage.

► Cut out and remove the area with a cutting knife.

► Lead the cable through the opening and secure.

3.2.2 Shell mounting of the concealed connection box

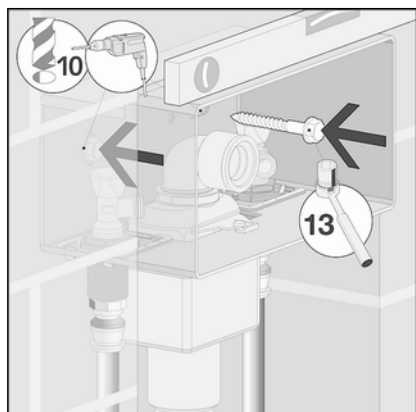

- Use a spirit level to align the concealed connection box.
- Attach the concealed connection box with the dowels and screws comprised in the delivery.
- Connect to an appropriate drinking water piping system.

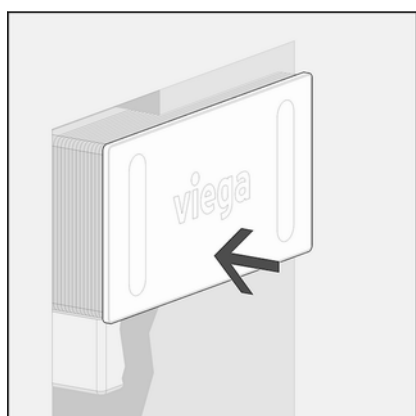

- Place the site protection.
- Fill in the gap between the concealed connection box and the wall.
 - ⇒ The wall is now ready for plastering.

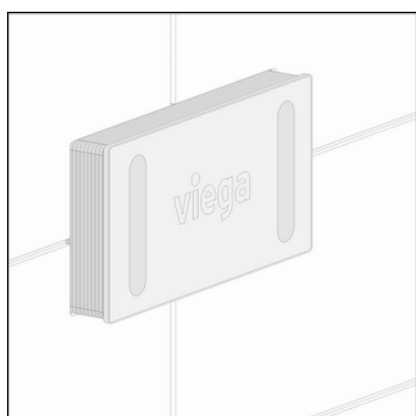

- Tile the wall.

3.2.3 Final assembly of the concealed connection box

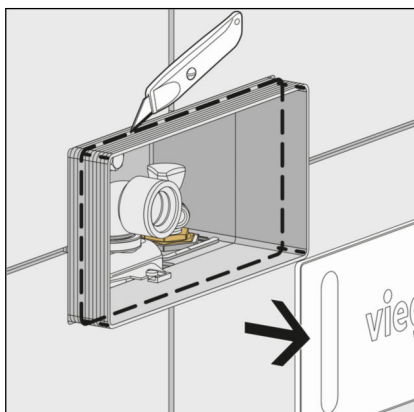

- Remove the site protection.
- Cut the shaft of the concealed connection box flush with tiles.

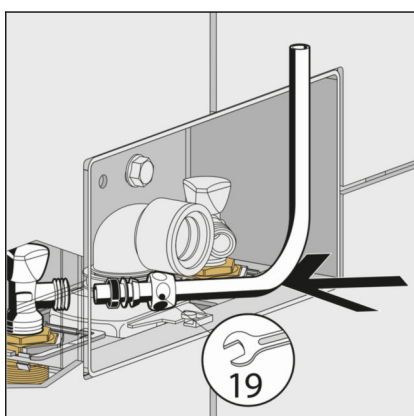

- Manufacture the connection for the washbasin fitting on one side above the copper pipe supplied.
- If necessary, the chrome-plated pipe elbow supplied must be cut to the corresponding length.

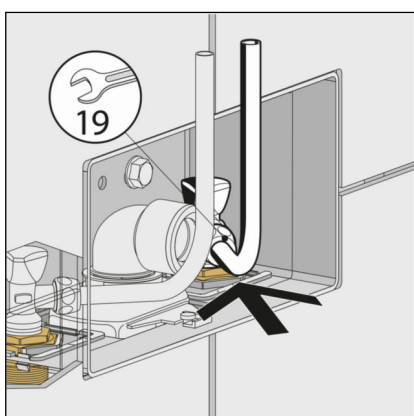

- Manufacture the second connection on the other side in the same way.

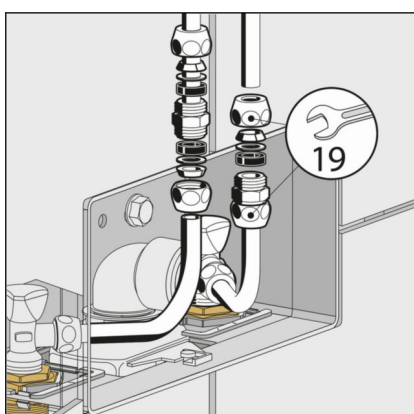

- Shorten copper pipe. The connection of the compression screw fitting must be within the concealed connection box.
- Attach compression screw fitting.

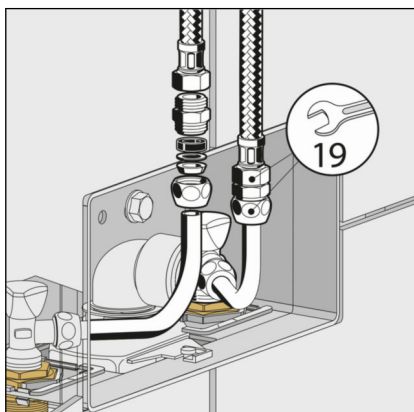

- Optionally, the washbasin fitting can also be connected to the concealed connection box using flexible hoses.

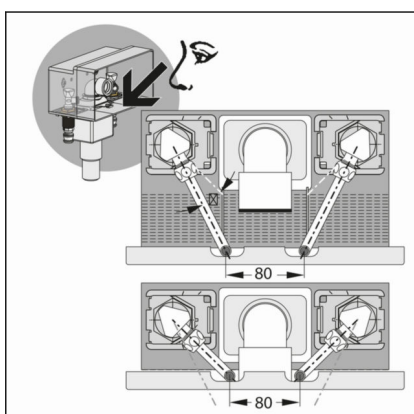

- Align corner valves.

When doing so, align the pipe elbow to the marking aid (line on the concealed connection box).

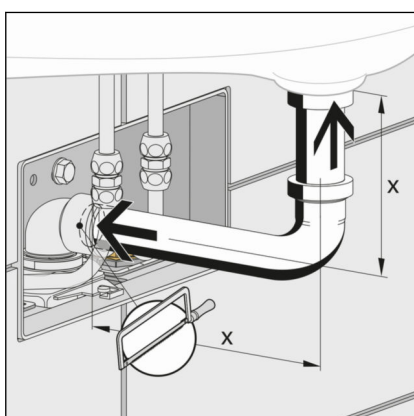

- Insert the drain elbow into the lip seal of the odour trap.
- Identify sizes on the drain elbow and adjusting pipe that may have to be shortened.

The sizes are marked in the diagram with *X* and are dependent on the chosen washbasin fitting.

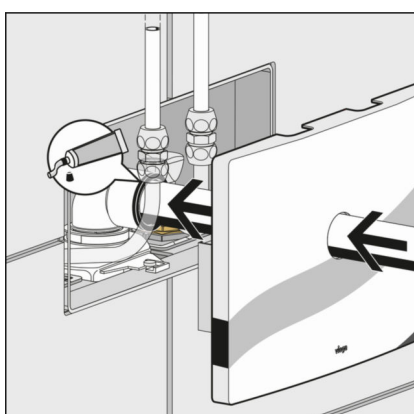

- Deburr cut edge.
- Grease lip seal.
- Insert the drain elbow through the cover plate in the lip seal of the odour trap.

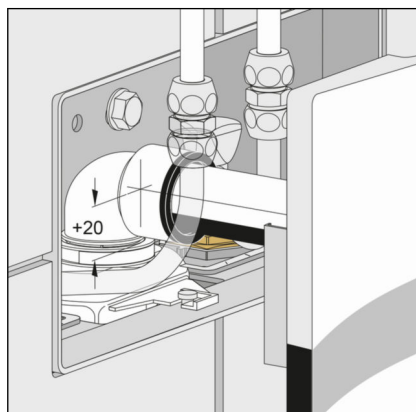

- Set the odour trap to the right size at the height.
The vertical setting range is 20 mm.

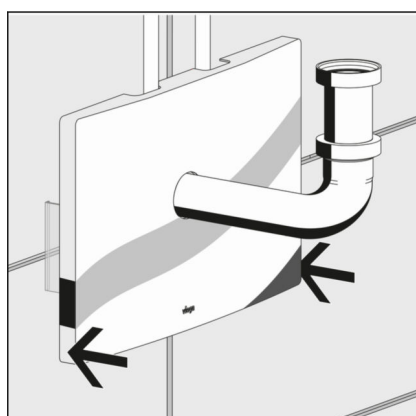

- Attach the cover plate to the concealed connection box.
The lateral supports serve as a safeguard against distortion.

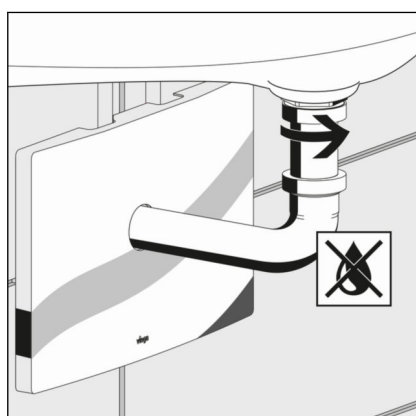

- Turn the drain elbow to the right and in doing so secure it to the washbasin.
When doing so, check for leaks.

3.3 Cleaning and maintenance

Replacing corner valves

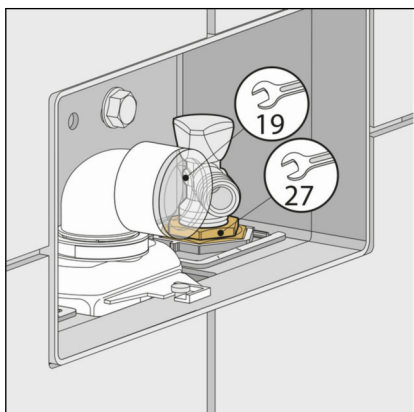

- Cut the water supply.
- When replacing the corner valve, counter the screw fitting with a spanner (size 27).

Cleaning the concealed odour trap

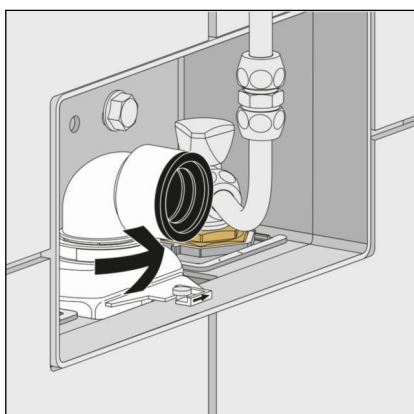

- Turn the odour trap anti-clockwise.
When doing so, unlatch the clip to the right.

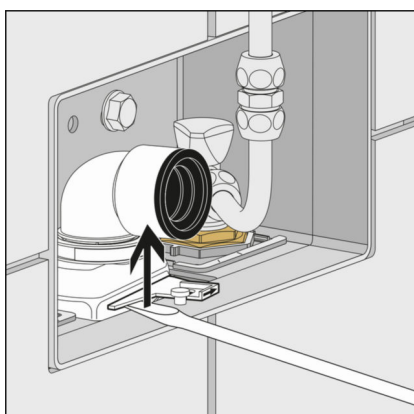

- Lift up the odour trap.

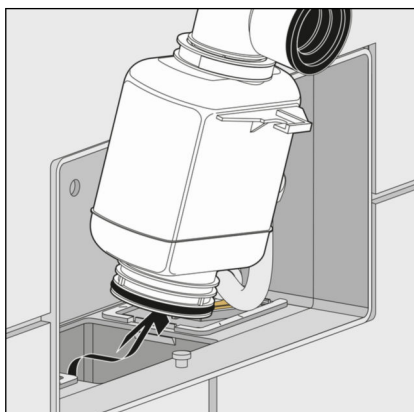

► Remove the odour trap for cleaning.

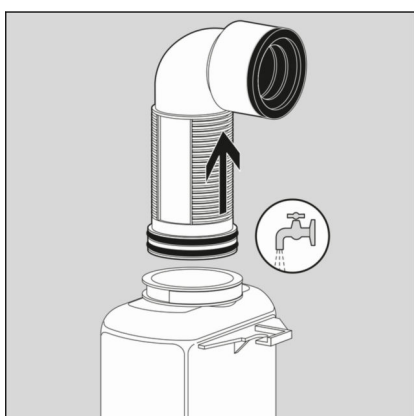

► Pull out the adjusting pipe upwards to clean.

3.4 Disposal

Separate the product and packaging materials (e. g. paper, metal, plastic or non-ferrous metals) and dispose of in accordance with valid national legal requirements.