

## Drain valve set

# Instructions for Use



for concealed cistern 1H, concealed cistern 2H, retrofit to flush plate Visign for Style or Visign for More

**Model**  
8310.0

**Year built:**  
from 07/2007

en\_INT

**viega**



# Table of contents

<b>1</b>	<b>About these instructions for use</b>	<b>4</b>
1.1	Target groups	4
1.2	Labelling of notes	4
1.3	About this translated version	5
<b>2</b>	<b>Product information</b>	<b>6</b>
2.1	Area of application	6
2.2	Product description	7
<b>3</b>	<b>Handling</b>	<b>8</b>
3.1	General mounting instructions	8
3.2	Assembly	8
3.2.1	Setting the flush volume	8
3.2.2	Removing the existing installation	9
3.2.3	Inserting the spare parts	12
3.3	Disposal	15

# 1 About these instructions for use

## 1.1 Target groups

The information in this instruction manual is directed at the following groups of people:

- Heating and sanitary professionals and trained personnel

It is not permitted for individuals without the abovementioned training or qualification to mount, install and, if required, maintain this product. This restriction does not extend to possible operating instructions.

The installation of Viega products must take place in accordance with the general rules of engineering and the Viega instructions for use.

## 1.2 Labelling of notes

Warning and advisory texts are set aside from the remainder of the text and are labelled with the relevant pictographs.



### **DANGER!**

This symbol warns against possible life-threatening injury.



### **WARNING!**

This symbol warns against possible serious injury.



### **CAUTION!**

This symbol warns against possible injury.



### **NOTICE!**

This symbol warns against possible damage to property.



*Notes give you additional helpful tips.*

### **1.3 About this translated version**

This instruction for use contains important information about the choice of product or system, assembly and commissioning as well as intended use and, if required, maintenance measures. The information about the products, their properties and application technology are based on the current standards in Europe (e. g. EN) and/or in Germany (e. g. DIN/DVGW).

Some passages in the text may refer to technical codes in Europe/Germany. These should serve as recommendations in the absence of corresponding national regulations. The relevant national laws, standards, regulations, directives and other technical provisions take priority over the German/European directives specified in this manual: The information herein is not binding for other countries and regions; as said above, they should be understood as a recommendation.

## 2 Product information

### 2.1 Area of application

The drain valve set is intended for retrofitting existing WC installations in such a way that one of the following Viega flush plates can be mounted:

- Visign for Style
  - Model 8315.1
  - Model 8331.1
  - Model 8332.1
  - Model 8332.3
  - Model 8332.4
  - Model 8333.1
  - Model 8334.1
- Visign for More
  - Model 8351.1
  - Model 8352.1
  - Model 8354.1
  - Model 8357.1

The drain valve set can be inserted in one of the following WC elements or WC modules:

- Viegaswift
  - Model 8000
  - Model 8000.90
  - Model 8000.99
  - Model 8032
  - Model 8039
  - Model 8112
- Steptec
  - Model 8461
- System Viega Eco Plus
  - Model 8161.5
  - Model 8161.80
  - Model 8161.90
- Mono
  - Model 8310



*The drain valve set can also be used as a spare part for the concealed cistern 2H.*

*After mounting the spare part, the existing WC flush plate can be re-mounted.*

## 2.2 Product description

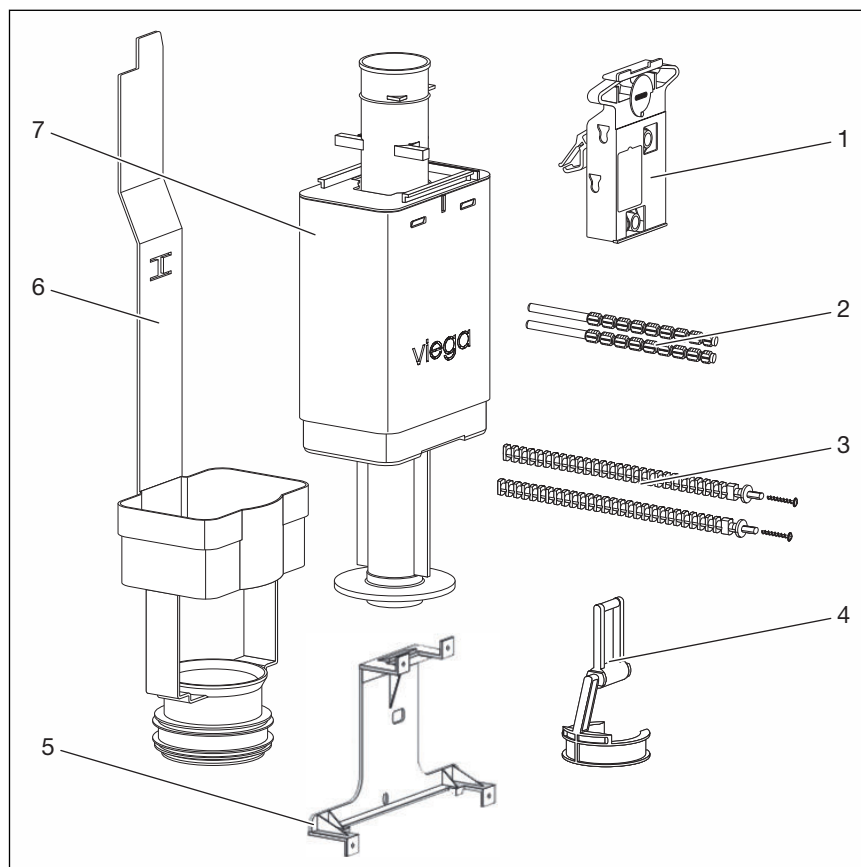

Fig. 1: Drain valve set

- 1 mechanism
- 2 actuating rods
- 3 threaded bolts and screws for fastening the flush plate
- 4 bow
- 5 support
- 6 drain valve seat
- 7 drain valve

### Flushing technology

The drain valve was developed for the dual flush technology with a small and a large flush volume. The small and large flush volumes are actuated by pressing the small or the large button in the flush plate.

### Factory settings of the flush volume

- Immediate re-flushing is possible because the cistern is not emptied completely.
- The small flush volume is set to approx. 3 l.
- The large flush volume is set to approx. 6 l.

If required, both flush volumes can be increased. For setting the flush volume, see: [Chapter 3.2.1 „Setting the flush volume“ on page 8](#)

# 3 Handling

## 3.1 General mounting instructions



*When you intend to install a new flush plate after retrofitting to the new flush valve, the parts of the existing flush plate can be discarded after dismantling.*

## 3.2 Assembly

### 3.2.1 Setting the flush volume

Before mounting the drain valve set, set the flush volume at the drain valve as follows:

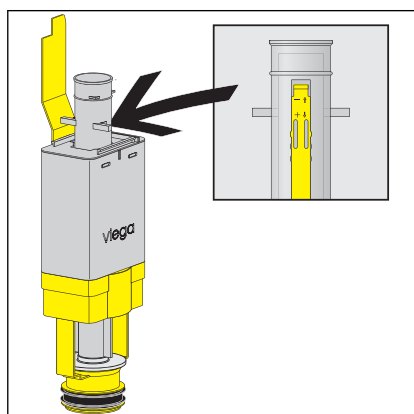

- Set the small flush volume at the slide control at the side of the overflow pipe.
  - Slide control in top position: approx. 3 litres
  - Slide control in bottom position: approx. 4 litres

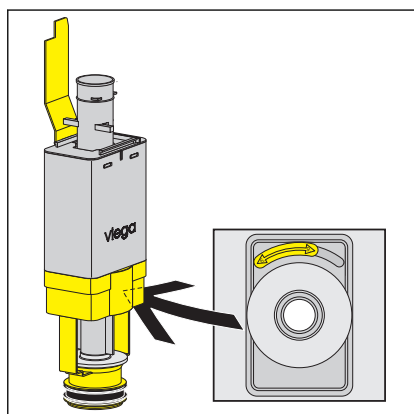

- Set the large flow volume at the slide control at the bottom of the drain valve.
  - Slide control in left position: approx. 6 litres
  - Slide control in right position: approx. 9 litres



### 3.2.2 Removing the existing installation



*The flush plate installed in your existing installation may differ from the plate shown in the illustration. However, the steps for removal will usually correspond to the steps shown in the following.*

To remove the existing installation, proceed as follows:

- Remove the flush plate.

Pull the plate off the wall as straight as possible.

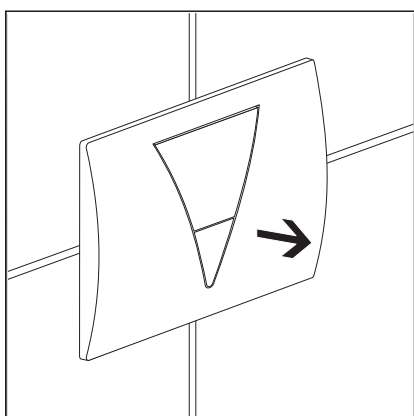

- Loosen the support at the top and the bottom and remove it from the installation shaft straight forward.

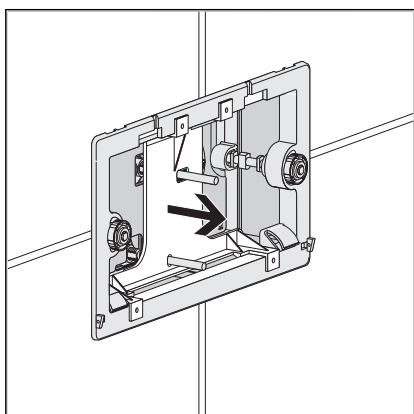

- Loosen the knurled nuts on the left and right side.
- Remove the basic panel.

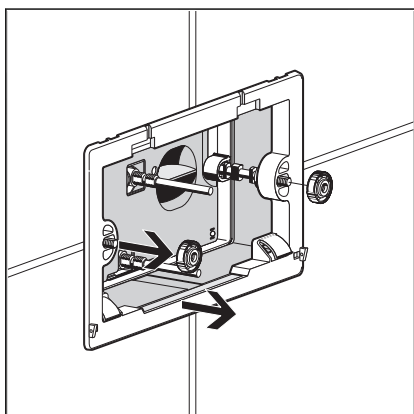

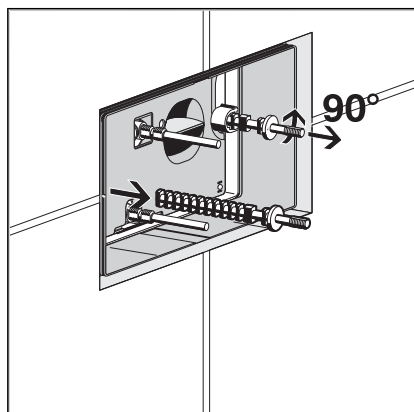

- Loosen the threaded bolts with a 90° turn.
- Remove the threaded bolts.

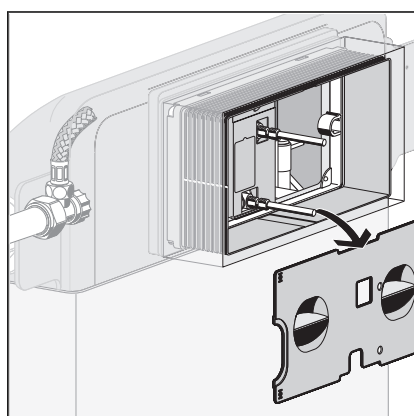

- Remove the cover straight forward from the installation shaft.

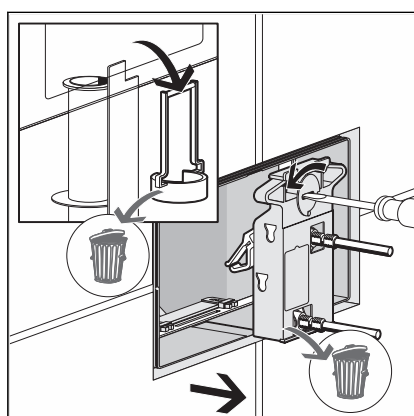

- Use a flat-blade screwdriver to turn the lock of the mechanism anti-clockwise through 90° to release the mechanism.
- Remove the mechanism from the installation shaft and dispose of it.
- Remove the bow of the drain valve and dispose of it.

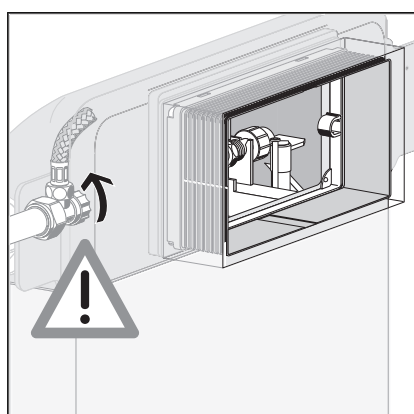

- Close the corner valve to shut the water supply off.

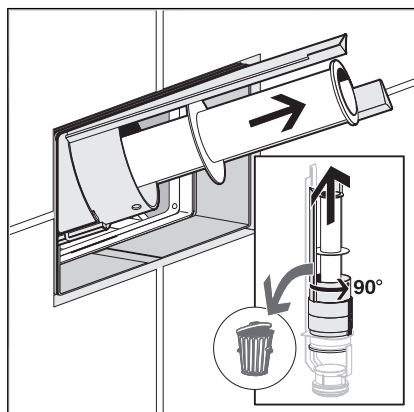

- Remove the drain valve and dispose of it.

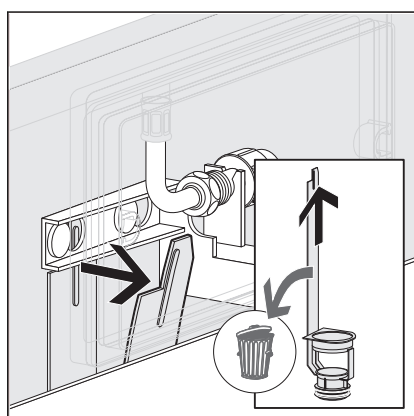

- Loosen the flap of the drain valve seat.
- Remove the drain valve seat and dispose of it.

### 3.2.3 Inserting the spare parts

Requirements:

- The water supply of the cistern has been closed.
- All parts of the existing installation you intend to replace have been removed.

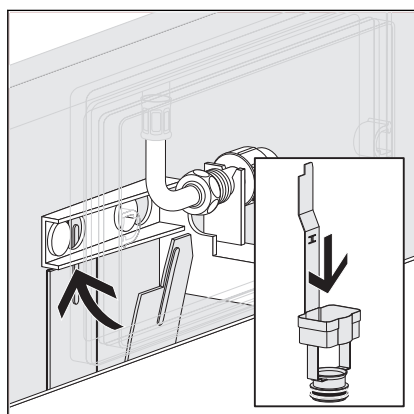

- Insert the new drain valve seat into the cistern.

Push the bottom end of the drain valve seat into the drain hole of the cistern as far as it will go.

- Fasten the flap of the drain valve seat behind the holder of the filling valve.

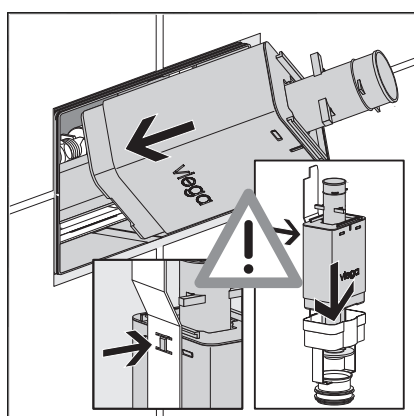

- Insert the drain valve in the drain valve seat.
- Fasten the rear of the drain valve at the drain valve seat as shown in the illustration.



*When you intend to install an electronic flush actuation or a touchless flush plate, follow the steps described in the instructions for use for the flush actuation or the flush plate from this point. In this case, you do not need to carry out the other assembly steps described in these instructions for use.*

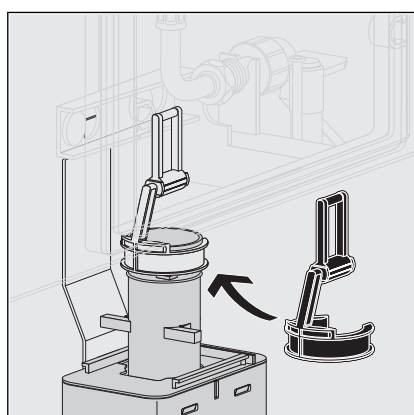

- Push the bow onto the drain valve from the left.

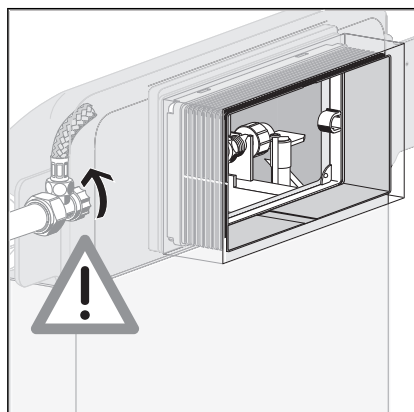

- Open the corner valve to enable the water supply.

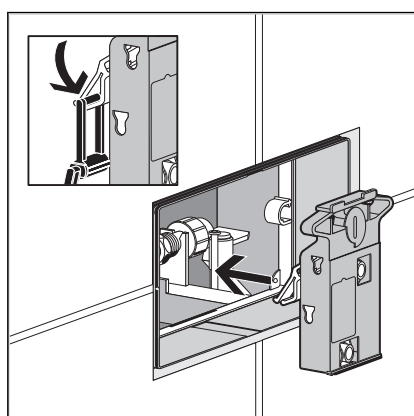

- Insert mechanism.  
Ensure that the edges of the mechanism sit exactly in the recesses in the shaft opening of the cistern.
- Hang the bow of the drain valve in the clip of the mechanism.

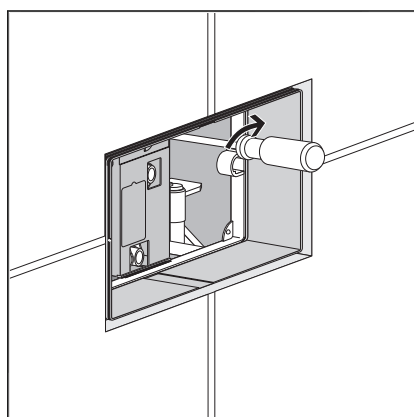

- Turn the mechanism's lock by 90° in a clockwise direction.  
⇒ The mechanism is locked.

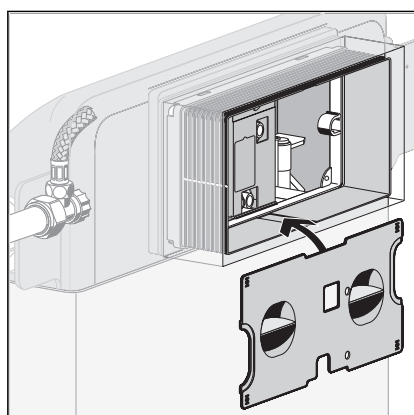

- Insert the cover.



*When you intend to mount a new flush plate, follow the instructions for use for the new flush plate from this point.*

*To re-install the old plate, follow the instructions in the next section.*

## Re-mounting the old flush plate

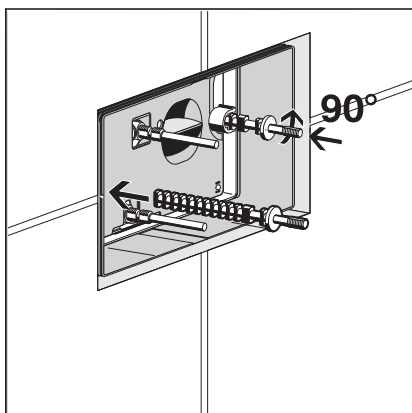

- Insert the old threaded bolts so deeply that the upper edge of the threaded bolt sticks out approx. 9 mm in front of the upper edge of the tiles.
- Fasten threaded bolts with a 90° turn.

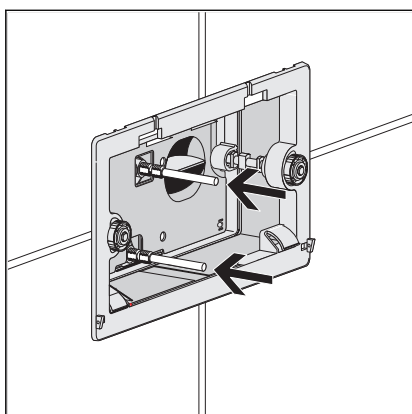

- Screw the actuating rods into the threaded holes of the mechanism.
  - Shorten the actuating rods with a knife.
- The top actuating rod must project 11 mm beyond the upper edge of the tiles.
- The bottom actuating rod must project 5 mm beyond the upper edge of the tiles.

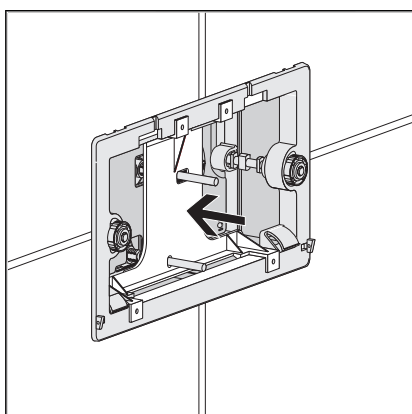

- Insert the support in the basic panel.

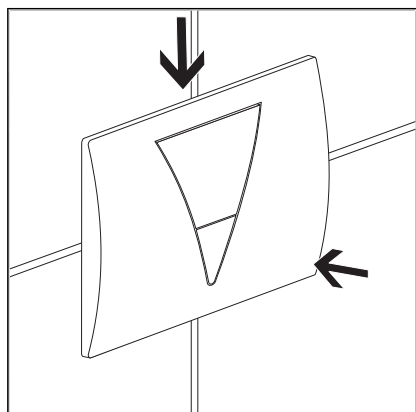

► Hang the flush plate from above in the basic panel press in below.

### 3.3 Disposal

Separate the product and packaging materials (e. g. paper, metal, plastic or non-ferrous metals) and dispose of in accordance with valid national legal requirements.